

Yetter

... for land's sake

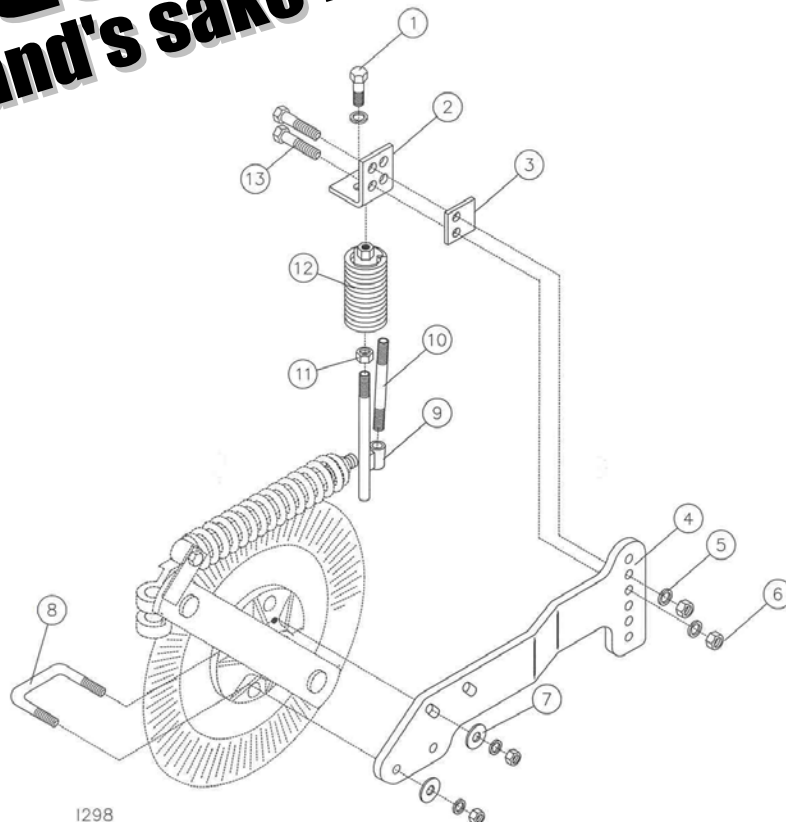

2910-114 HD LIQUID FERT. KIT, 2910

Key	Qty.	Part No.	Description
1	1	2502-292	1/2-13 X 1 HHCS Gr. 5 ZP
2	1	2995-301	Injector Mount Plate
3	1	2995-320	Spacer, Injector
4	1	2910-321	HD Injector Arm 2910
5	5	2525-352	1/2 Med. Lockwasher ZP
6	4	2520-352	1/2-13 Hex Nut ZP
7	2	2526-351	1/2 Std. Flatwasher ZP
8	1	2570-736	1/2 X 3-1/8 X 2-1/4 U-Bolt ZP
9	1	2995-212	Injector Rod W.A., 1/2-13
10	1	2515-311	3" Nipple, 1/4 NPT Stainless Steel
11	1	2520-356	1/2-13 Jam Hex Nut
12	1	2995-131	Injector Spring Assembly
13	2	2502-317	1/2-13 X 1-3/4 HHCS Gr. 5 ZP

YETTER MANUFACTURING CO.
 FOUNDED 1930

Colchester, IL 62326-0358
 Toll free: 800/447-5777
 309/776-3222 (Fax)
 Website: www.yetterco.com
 E-mail: info@yetterco.com

Yetter

2910-114 HD LIQUID FERTILIZER KIT

1. Mount HD injector arm (#4) to the coulter arm using a 1/2 x 3-1/8" x 2-1/4" u-bolt, two flatwashers, lockwashers and nuts as shown. Location of the u-bolt on the coulter arm will effect the depth that the injector rod w.a. operates.
2. Assemble the 3" stainless steel nipple (#10) to the injector rod w.a. (#9).
NOTE: A female hose barb (not supplied) will be required. Also a straight stream nozzle 1/4 NPT male thread will be required (not supplied). A check valve may be installed to minimize fertilizer waste.
3. Thread a 1/2" hex jam nut onto the injector rod w.a. with at least 3/4" threads showing. Now thread the injector spring assembly (#12) onto the injector rod. Now jam lock the injector rod to the spring assembly using the 1/2" jam hex nut.
4. Install the injector rod/spring assembly to the injector mount plate (#2) using a 1/2 x 1" bolt and one 1/2" lockwasher.
NOTE: The injector rod assembly is to be installed so that the stream nozzle is on the trailing or rear side of the injector rod.
5. Bolt injector assembly to HD injector arm with one spacer (#3), two 1/2 x 1-3/4" bolts, lockwashers and nuts.
6. Operating depth is adjusted by selecting different holes vertically in the HD injector arm.
7. For exact alignment of the injector rod to the coulter blade, a spacer (#3) is included.
8. Securely tighten all hardware.
9. Inspect the assembly after four hours of use for loose hardware.