

MAX FLOW
MAX PRESSURE
RATED PUMP SPEED
POWER REQUIREMENT
LUBRICATION

4.0 GPM / 15 L/MIN
3000 PSI / 200 BAR
1450 RPM
8.0 HP ELECTRIC
16 OZ UDOR LUBE

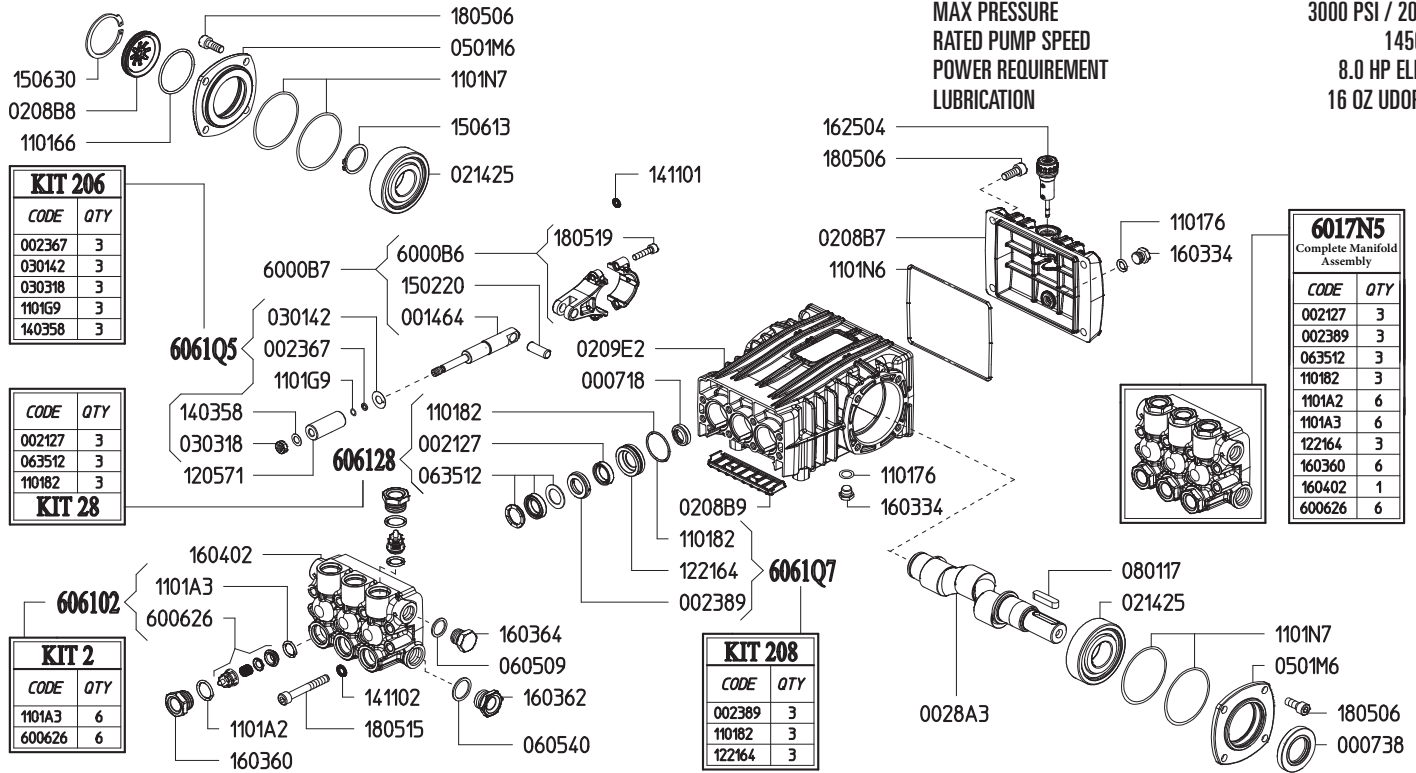

Part #	Description	Qty
0007.18	OIL SEAL D15X24X5	3
0007.38	OIL SEAL D30	1
0014.64	PLUNGER GUIDE "B/BK"	3
0021.27	WATER SEAL LP D18 ^{B E}	3
0023.67	RING D5.2X8X1.3 ^C	3
0023.89	UPPER RING D18 "B/BK" ^{D E}	3
0028.A3	MALE SHAFT "B/BK" D24	1
0208.B7	BACK COVER "B/BK"	1
0208.B8	COVER "B/BK"	1
0208.B9	COVER "B/BK"	1
0209.E2	CRANKCASE "B-X/BK-X"	1
0214.25	BALL BEARING D30	2
0301.42	DISC ^C	3
0303.18	NUT M8XH5 ^C	3
0501.M6	BEARING FLANGE "B/BK"	2
0605.09	GASKET D17X23X1.5	1
0605.40	GASKET D21.5X27X1.5	1
0635.12	HIGH PRESSURE SEAL KIT D18 ^{B E}	3
0801.17	KEY A8X7X35 UNI6604	1
1101.66	O-RING D44.12 (RIF.3175)	3
1101.76	O-RING D9.13 (RIF.109)	1
1101.82	O-RING D31.47X1.78 (RIF 2125) ^{B D E}	2
1101.A2	O-RING D17.86 (RIF.123) ^E	6
1101.A3	O-RING D13.9X2.62 (RIF 3056) ^{A E}	6
1101.G9	O-RING D4.48 (RIF 2018) ^C	3
1101.N6	O-RING D126.67 (RIF 3500)	1
1101.N7	O-RING D68	4
1205.71	CERAMIC PLUNGER D18 "B/BK"	3

Part #	Description	Qty
1221.64	PRESSURE RING D18 "B/BK" ^{D E}	3
1403.58	WASHER D8 ^C	3
1411.01	SCHNOOR WASHER D6	6
1411.02	SCHNOOR WASHER D8	8
1502.20	PIN D10X27	3
1506.13	SNAP RING D30	1
1506.30	SNAP RING D52	1
1603.34	PLUG G1/4	2
1603.60	VALVE PLUG D15/18/20 ^E	6
1603.62	PLUG G1/2	1
1603.64	PLUG G3/8	1
1604.02	HEAD "B-X" ^E	1
1625.04	OIL PLUG G3/8	1
1805.06	ALLEN BOLT M8X20	8
1805.15	ALLEN BOLT M8X60	8
1805.19	ALLEN BOLT M8X25	6
6000.B6	ROD ASSY "B/BK"	3
6006.26	VALVE ASSY WITHOUT O-RING ^{A E}	6
6017.N5	COMPLETE MANIFOLD ASSEMBLY	1
6061.02	KIT 2 - VALVE KIT "PK/M/B"	1
6061.28	KIT 28 - WATER SEAL KIT	1
6061.Q5	KIT 206 - PLUNGER KIT D15/18 "B/BK"	1
6061.Q7	KIT 208 - BRASS RING KIT D18 "B/BK"	1

^A Parts in 6061.02 (Kit 2).

^B Parts in 6061.28 (Kit 28).

^C Parts in 6061.Q5 (Kit 206).

^D Parts in 6061.Q7 (Kit 208).

^E Parts in 6017.N5 (Complete Manifold Assembly).