

**Models 9910-D1304, -D1504, -D1554 Hypro**

**NOTE:** When ordering parts, give QUANTITY, PART NUMBER, DESCRIPTION, and COMPLETE MODEL NUMBER. Reference numbers are used ONLY to identify parts in the drawing and are NOT to be used as order numbers.

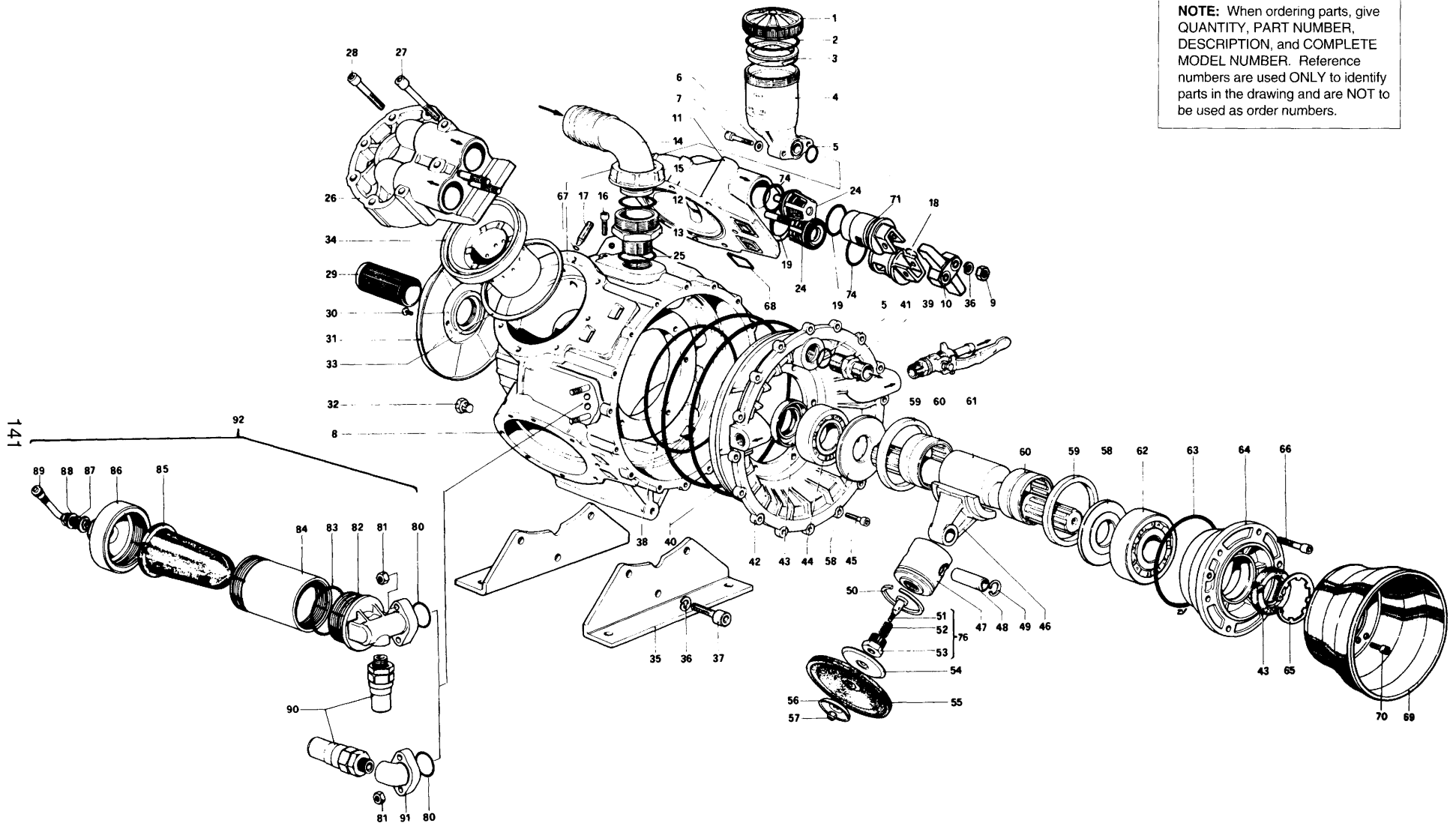

# HYPRO PUMPS • 2/2002

REF. NO.	PART NUMBER	DESCRIPTION	QTY. REQ'D.
1	9910-750056	Oil Cap	1
▲ 2	9910-580230	O-Ring	1
3	9910-680040	Sealing Cap	1
4	9910-680030	Oil Reservoir	1
▲ 5	9910-390180	O-Ring	2
6	9910-380241	Washer	2
7	9910-680350	Bolt	2
8	9910-850010	Pump Body	1
9	9910-851300	Nut	8
10	9910-850271	Valve Retainer	4
11	9910-850103	Head (Right Hand)	2
▲ 12	9910-390201	O-Ring	1
13	9910-391920	Adapter Nut	1
14	9910-540550	Hose Barb	1
15	9910-540540	Barb Nut	1
16	9910-850370	Bolt	1
17	9910-850190	Bleeder Bolt	4
18	9910-850161	Valve Retainer, Suction	4
□▲ 19	9910-230060	O-Ring	8
□ 24	9910-909050	Valve Assy	8
▲ 25	9910-540360	O-Ring	1
26	9910-850104	Head (Left Hand)	2
27	9910-850260	Bolt	12
28	9910-620870	Bolt	20
29	9910-850920	Shaft Protector	1
30	9910-850930	Screw	3
31	9910-850910	Protector Housing	1
32	9910-1 30171	Drain Plug	1
33	9910-850280	Gasket	4
34	9910-850111	Piston Sleeve (Model 9910-D1304)	4
34	9910-850110	Piston Sleeve (Model 9910-D1504)	4
35	9910-850200	Base	2
36	9910-250141	Washer	8
37	9910-850330	Bolt	6
▲ 38	9910-850300	O-Ring	1
39	9910-160140	Ball Valve	2
▲ 40	9910-850310	O-Ring	2
41	9910-850740	Outlet Fitting	1
42	9910-850150	Discharge Manifold	1
43	9910-230380	Seal	2
44	9910-230350	Bearing	1
45	9910-320360	Bolt	16
46	9910-850140	Connecting Rod	4
47	9910-850121	Piston (Model 9910-D1304)	4
47	9910-850120	Piston (Model 9910-D1504)	4

REF. NO.	PART NUMBER	DESCRIPTION	QTY. REQ'D
48	9910-160700	Wrist Pin (Model 9910-D1304)	4
48	9910-650071	Wrist Pin (Model 9910-D1504)	4
49	9910-160691	Retainer Ring	8
50	9910-850240	Piston Ring (Model 9910-D1304)	4
50	9910-260231	Piston Ring (Model 9910-D1504)	4
51	9910-850220	Retaining Bolt	4
52	9910-850090	Spring	4
53	9910-850230	Lock Nut	4
54	9910-650090	Support Washer	4
■ 55	9910-850085	Diaphragm, Desmopan (Std)	4
55	9910-85008T	Diaphragm, Teflon (Opt)	4
55	9910-850080	Diaphragm, Buna-N (Opt)	4
56	9910-650390	Retainer Washer	4
57	9910-160311	Lock Nut	4
58	9910-540040	Spacer	2
59	9910-850130	Retaining Ring	2
60	9910-850320	Bearing	2
61	9910-850170	Crankshaft	1
62	9910-160750	Bearing	1
▲ 63	9910-850290	O-Ring	1
64	9910-850020	Seal Retainer	1
65	9910-200390	Retaining Ring	1
66	9910-540310	Bolt	6
▲ 67	9910-851280	O-Ring	4
■ 68	9910-850030	Gasket	8
69	9910-1500350	Shield	1
70	9910-180431	Bolt	3
71	9910-850181	Valve Holder, Discharge	4
72	9910-200231	Lock Washers	40
73	9910-851250	Stud	2
▲ 74	9910-680070	O-Ring	8
76	9910-859080	Retaining Bolt, Spring, Nut Assy	1
▲ 80	9910-390290	O-Ring	1
81	9910-380240	Nut	2
82	9910-851210	Pulsation Damper Support	1
83	9910-851270	O-Ring	1
84	9910-851220	Pulsation Damper Cylinder	1
85	9910-851230	Pulsation Damper Diaphragm	1
85	9910-85123T	Pulsation Damper Diaphragm Teflon (opt.)	1
86	9910-851240	Cap	1
87	9910-650542	O-Ring	1
88	9910-380241	Lock Washer	1
89	9910-380440	Air Valve	1
90	9910-269050	Relief Valve	1
91	9910-851260	Mounting Flange	1
92	9910-KIT1526	Pulsation Damper Assy	1

### REPAIR & MAINTENANCE KITS AVAILABLE

- Diaphragm Parts Kit No. 9910-KIT1734 consists of: Ref. 55 (4 ea.) Diaphragm, Ref. 68 (8 ea.) Gasket.
- Valve Parts Kit No. 9910-KIT1965 consists of: Ref. 19 (16 ea.) O-Rings, Ref. 24 (8 ea.) Valves.

- ▲ O-Ring Parts Kit No. 9910-KIT1744 consists of: Ref. 2 (1) O-Ring, Ref. 5 (2 ea.) O-Ring, Ref. 12 (1) O-Ring, Ref. 19 (8 ea.) O-Rings, Ref. 25 (1) O-Ring, Ref. 38 (1) O-Ring, Ref. 40 (2 ea.) O-Ring, Ref. 63 (1) O-Ring, Ref. 67 (4 ea.) O-Rings, Ref. 74 (8 ea.) O-Rings, Ref. 80 (1) O-Ring.