

Series 9000 • Gear Driven Centrifugal Pump

Hypro®

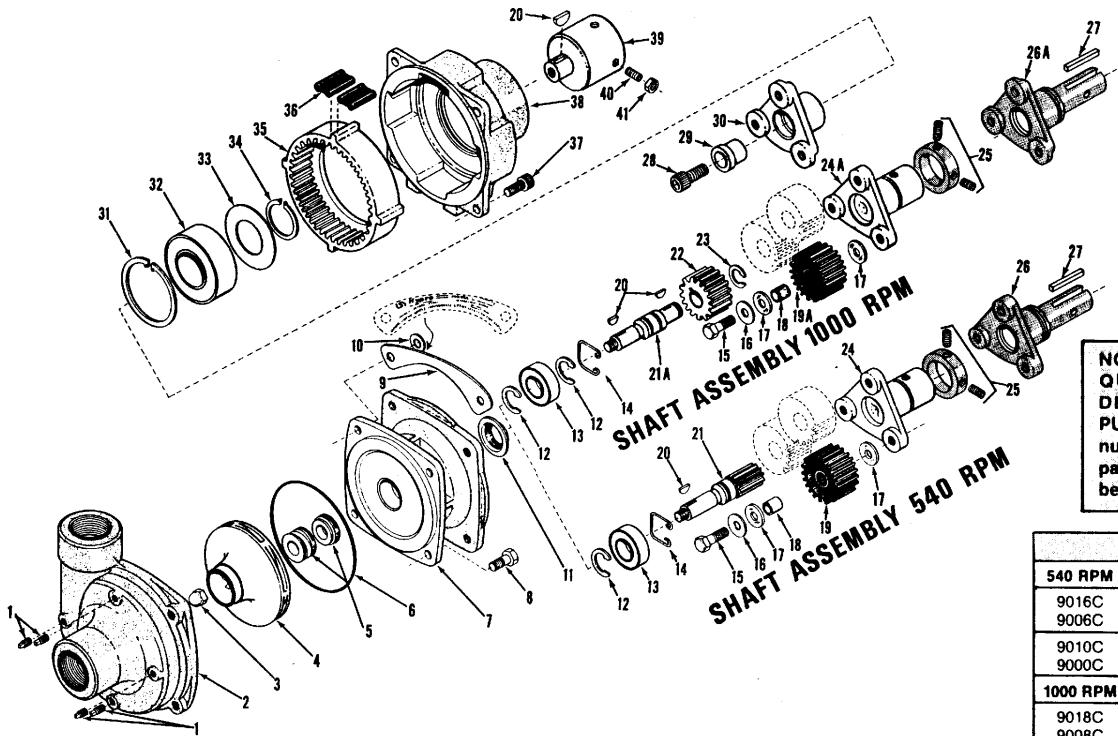

NOTE: When ordering parts, give QUANTITY, PART NUMBER, DESCRIPTION, and COMPLETE PUMP MODEL NUMBER. Reference numbers are used ONLY to identify parts in the drawing and are NOT to be used as order numbers.

MODEL DESIGNATIONS		
540 RPM	DRIVER HUB	SEAL
9016C	1" Solid	Viton (Standard)
9006C	1 1/2" Hollow	Viton (Standard)
9010C	1" Solid	Buna-N (Optional)
9000C	1 1/2" Hollow	Buna-N (Optional)
1000 RPM	DRIVER HUB	SEAL
9018C	1" Solid	Viton (Standard)
9008C	1 1/2" Hollow	Viton (Standard)
9028C	1 1/2" Hollow	Viton (Standard)
9012C	1" Solid	Buna-N (Optional)
9002C	1 1/2" Hollow	Buna-N (Optional)
9022C	1 1/2" Hollow	Buna-N (Optional)

REF. NO.	QUANTITY REQUIRED	PART NUMBER	DESCRIPTION
1	4	2406-0009	Pipe Plug
2	1	0150-9000C	Pump Casing
3	1	2253-0001	Impeller Nut
4	1	0400-9000P	Impeller (Nylon)
5	1	9501-0018	Mechanical Seal - Buna-N (For Models 9000C, 9002C, 9010C, 9012C, 9022C)
5	1	9501-0050	Mechanical Seal - Viton (For Models 9006C, 9008C, 9016C, 9018C, 9028C)
6	1	1720-0083	O-Ring
7	1	0750-9000C	Mounting Flange Adapter
8	4	2210-0020	Hex Head Capscrew
9	1	0601-	Nameplate (Specify Model Number)
10	2	2270-0004	Washers for Nameplate
11	1	2130-0017	Bearing Lip Seal
12	*	1810-0013	Retaining Ring-*1 required for 540 RPM Models 9000C, 9006C, 9010C, 9016C; 2 required for 1000 RPM Models 9002C, 9008C, 9012C, 9018C, 9022C, 9028C.
13	1	2008-0001	Ball Bearing
14	1	1820-0025	Retaining Ring
15	3	2210-0046	Hex Head Capscrew
16	3	2270-0003	Washer
17	6	2265-0003	Thrustwasher
18	3	2207-0022	Bearing Inner Race
19	3	3900-0015	Driver Gear with Bearing (For 540 RPM Models 9000C, 9006C, 9010C, 9016C)
19A	3	3900-0016	Driver Gear with Bearing (For 1000 RPM Models 9002C, 9008C, 9012C, 9018C, 9022C, 9028C)
20	**	1610-0012	Woodruff Key-**1 required for 540 RPM Models 9000C, 9006C, 9010C, 9016C; 2 required for 1000 RPM Models 9002C, 9008C, 9012C, 9018C; 3 required for 1000 RPM Models 9022C, 9028C
21	1	3900-0010	Pinion geared impeller shaft (For 540 RPM Models 9000C, 9006C, 9010C, 9016C)

REF. NO.	QUANTITY REQUIRED	PART NUMBER	DESCRIPTION
21A	1	0500-9002	Impeller Shaft (For 1000 RPM Models 9002C, 9008C, 9012C, 9018C, 9022C, 9028C)
22	1	3900-0013	Sun Gear (1000 RPM Models)
23	1	1810-0011	Retaining Ring (for sun gear)
24	1	0560-9000D	Driver Hub (1 1/2" 540 RPM Splined PTO) For Models 9000C, 9006C
24A	1	0560-9002D	Driver Hub (1 1/2" 1000 RPM Splined PTO) For Models 9002C, 9008C
25	1	3430-0176	Locking Collar Kit for 1 1/2" hollow shaft models only (540 & 1000 RPM)
26	1	0500-9016D	Driver Hub (1" solid shaft) For 540 RPM Models 9010C, 9016C
26A	1	0500-9018D	Driver Hub (1" solid shaft) For 1000 RPM Models 9012C, 9018C
27	1	1610-0005	1/4" Key for 1" solid shaft driver hubs 540 & 1000 RPM Models
28	1	2220-0035	Socket Head Capscrew For Models 9022C, 9028C
29	1	2403-0012	Bushing (For Models 9022C, 9028C)
30	1	0552-9002D	Driver Hub for Planetary Gears For Models 9022C, 9028C
31	1	1820-0009	Retaining Ring
32	1	2005-0002	Ball Bearing
33	1	1410-0006	Slinger
34	1	1810-0001	Retaining Ring
35	1	3900-0009	Ring Gear
36	8	1450-0004	Cushion Bumper
37	4	2220-0004	Hex Head Capscrew
38	1	0751-9000C	Gear Casing
39	1	0550-9028	Driver Hub (1 1/2" 1000 RPM Splined PTO) For Models 9022C, 9028C
40	2	2230-0004	Set Screw (For Models 9022C, 9028C)
41	2	2250-0037	Locknut (For Models 9022C, 9028C)