

# 3375-0015, 0017 Pulsation Dampeners

## Hypro®

### REPAIR INSTRUCTIONS

**CAUTION! Always release nitrogen pressure before disassembling damper.**

1. Remove valve cap and depress valve core stem to release nitrogen pressure.
2. Clamp dampener in vise by port at bottom of body. Turn socket head bolts counter-clockwise to remove the cover.
3. To remove the valve core, use a standard automotive valve core extractor. Replace if damaged or worn.  
**NOTE: The valve core is a special 2000 psi (13800 kPa) high pressure type. A conventional automotive tire core is not suitable for use with this damper.** The entire check valve assembly may be removed by taking off the lock nut and loosening the valve core housing with a 7/16" socket wrench from inside the cover.
4. Remove diaphragm and baffle plug. Inspect and replace as necessary.
5. Replace cover, tighten socket head bolts to 90-95 foot pounds of torque.
6. Recharge damper. Check flanges and valve core for leakage. Leaks may be detected by applying soapy water with a brush. Watch for air bubbles.

### REPAIR INSTRUCTIONS

### PARTS DRAWING MODEL 3375-0015, -0017

Ref. No.	Part Number	Description
1	2220-0037	Socket Head Bolts (6), Model 3375-0015
1	2220-0033	Socket Head Bolts (3), Model 3375-0017
2		Valve Cap
3	2250-0025	Lock Nut
4	6031-0308	Decal, Model 3375-0015
4	6031-0308	Decal, Model 3375-0017
5	0201-3375D	Cover, Model 3375-0015
5	0202-3375D	Cover, Model 3375-0017
6	3320-0017	Check Valve Assembly: Consists of Valve Cap No. 2253-0004, Valve Core No. 2404-0106, O-ring No. 1720-0109, and Check Valve Body No. 3200-0041.
7		Valve Core
8		O-ring
9		Check Valve Body
10	2535-0008	Diaphragm (Buna-N), Model 3375-0015
10	2535-0003	Diaphragm (Buna-N), Model 3375-0017
11	2404-0251	Baffle Plug, Model 3375-0015
11	2404-0257	Baffle Plug, Model 3375-0017
12	0103-3375D	Body, Model 3375-0015
12	0102-3375D2	Body, Model 3375-0017

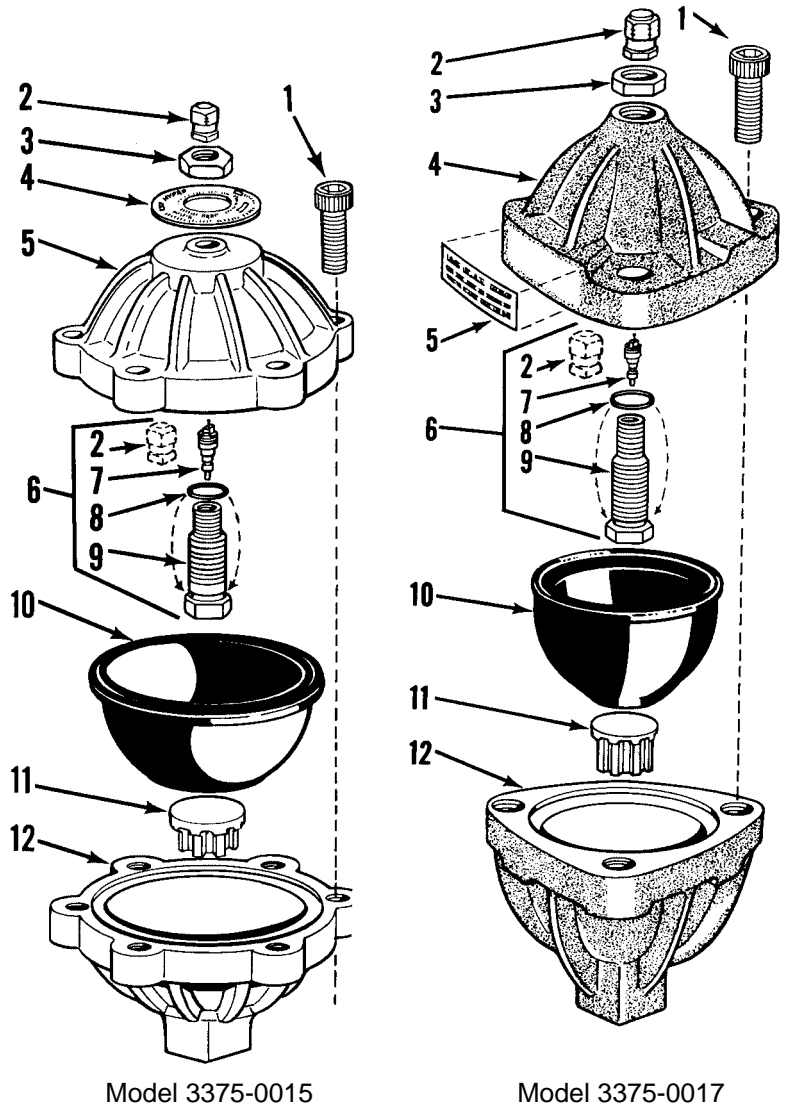

Model 3375-0015

Model 3375-0017