

DEMA[®]

900-WC



OWNER'S MANUAL

**THIS UNIT DOES NOT INCLUDE A WATER BACKFLOW PREVENTER,
CHECK LOCAL PLUMBING CODES FOR PROPER INSTALLATION.**



900-WC

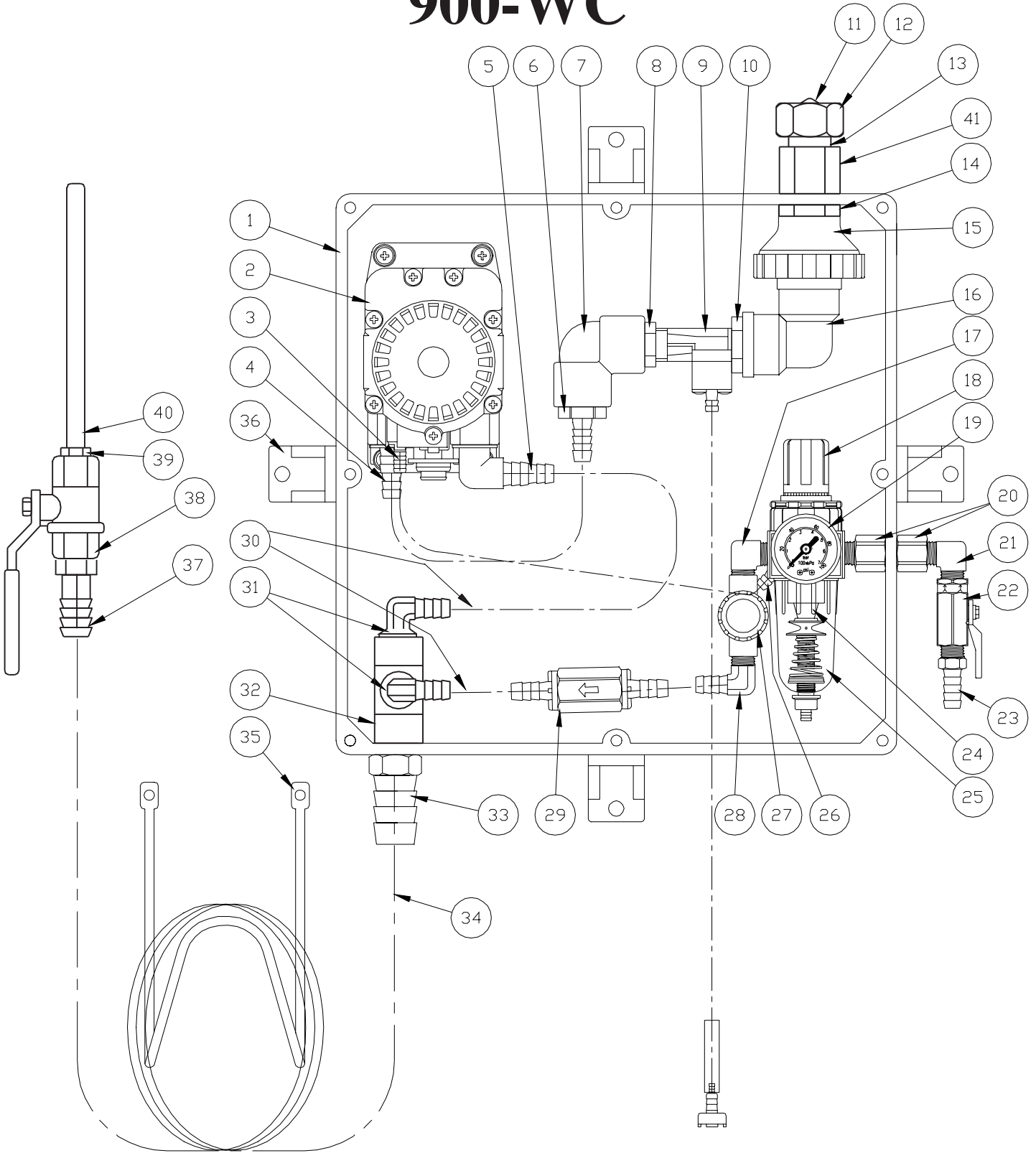

FRONT VIEW - CONTROL BOX
COVER REMOVED

DEMA[®]**900-WC****PARTS LIST**

ITEM	PART NO.	DESCRIPTION
1	9PB12126	12X12X6 POLYETHYLENE BOX
2	9P56	PUMP
3	9HB14P	PUMP AIR INLET HOSE BARB 1/4"
4	9HB5638	PUMP HOSE BARB 3/8"
5	9HBEL5638	PUMP HOSE BARB 3/8"
6	9HB1238	POLY HOSE BARB 1/2" MPT x 3/8" BARB
7	9PEL12F	POLY ELBOW 1/2" FPT
8	9HHPB1238	POLY BUSHING 1/2" MPT x 3/8" FPT
9	9P203CT	INJECTOR ASSEMBLY (INCLUDES INTAKE HOSE & TIP KIT)
	9P203CT-IH	REPLACEMENT INTAKE HOSE ASSEMBLY FOR P203CT
	9P203CT-TIPS	REPLACEMENT TIP KIT FOR P203CT
10	9HHPB3438	POLY BUSHING 3/4" MPT x 3/8" FPT
11	9STR34	GARDEN HOSE STRAINER
12	9SNB34GH	GARDEN HOSE SWIVEL NUT
13	9SA12B	SWIVEL ADAPTER 1/2" MPT
14	9HHBB34GH12	HEX HEAD BRASS BUSHING 3/4in MGH BY 12 FPT
15	9WR15G34	WATER PRESSURE REGULATOR - 3/4in FGH BY 3/4in MPT
16	9PEL34F	POLY ELBOW 3/4" FPT
17	9BEL14M14M	BRASS ELBOW 1/4" MPT
18	9R15	AIR PRESSURE REGULATOR & FILTER (INCLUDES # 24 & 25)
19	9AG100	AIR PRESSURE GAUGE
20	9BA25	ADAPTER 1/4" FPT x 1/4" MPT
21	9BEL14M14M	BRASS ELBOW 1/4" MPT
22	9BVB14	BALL VALVE 1/4" FPT
23	9HBB1438	HOSE BARB 1/4" MPT x 3/8" BARB
24	9AFR15	REPLACEMENT AIR FILTER ELEMENT
25	9ABR15	REPLACEMENT AIR BOWL
26	9HBBEL1814	HOSE BARB ELBOW 1/8" MPT x 1/4" BARB
27	9NV14Y	NEEDLE VALVE (WET FOAM / DRY FOAM)
28	9HBBEL1438	BRASS HOSE BARB ELBOW 1/4" MPT x 3/8" BARB
29	9CV38	PVC CHECK VALVE
30	9HBSEL1238	304 S.S. 1/2in MPT BY 3/8in H.B. ELBOW
32	9SST12	S.S. TEE 1/2" FPT
33	9HBSS1234	S.S. HOSE BARB 1/2" MPT x 3/4" BARB
34	9H34-50'	FOAM DISCHARGE HOSE 3/4" ID x 50'
35	9SSH	S.S. HOSE HANGER
36	9PBFTS	POLYETHYLENE BOX MOUNTING FOOT WITH SCREW
37	9HBSS1234	S.S. HOSE BARB 1/2" MPT x 3/4" BARB
38	9HV60	S.S. BALL VALVE 1/2" FPT
39	9HHSB1238	S.S. HEX HEAD BUSHING 1/2" X 3/8"
40	9W387	STAINLESS STEEL WAND ASSEMBLY FOR 3/4in HOSE - 3/8in WAND
	9PL1212-WCSS	12X12 POLYETHYLENE LID & DECAL



900-WC

SAFETY INSTRUCTIONS

1. Always wear safety goggles and protective gloves while operating foam unit.
2. Avoid contact of cleaning solution with skin and eyes. If contact occurs, see products MSDS and seek medical attention if needed.
3. After use, close the air inlet valve (item# 22) and relieve all remaining pressure in the system by opening the discharge ball valve (item# 38). When all pressure has been relieved, close the discharge ball valve.
4. Never point the discharge wand toward anyone.

INSTALLATION INSTRUCTIONS

1. Read all instructions before installing the unit.
2. Remove all parts from the shipping box.
3. Select desired area to mount the control box, making sure the chemical intake hose will reach the bottom of the chemical container.
4. Mount the control box and the hose hanger (item# 35) using the screws provided.
Note: Use a 5/16" drill bit to drill holes for the plastic anchors.
5. Attach the discharge hose (item# 34) to the hose barb (item# 33) and secure it with the included hose clamp.
6. Attach a 3/8" ID compressed air line from an air compressor to the air inlet hose barb (item# 23).
Note: The air compressor should be able to maintain 3 - 5 cfm @ 60 psi.
7. Connect a water line to the water inlet nut (item# 12). (**A backflow preventer must be installed in the water line, check local codes to ensure proper installation**).
8. Remove the pvc cover from the control box. Using the chart below, insert the proper metering tip and connect the chemical intake line to the injector (item# 9) inlet barb. Insert the other end of the chemical intake line into the chemical container.

Metering Tip Color	Oz./Gal.	Ratio
Turquoise	0.40	320-1
Pink	0.80	160-1
Light Blue	0.95	135-1
Brown	1.30	98-1
Red	1.40	92-1
White	1.85	69-1
Green	1.90	67-1
Blue	2.65	48-1
Yellow	2.95	43-1
Black	4.80	27-1
Purple	6.40	20-1
Gray	6.80	19-1
No Tip	9.20	14-1

Injection rate based on:

- Chemical viscosity of 1 cp
(*water viscosity = 1 cp*).
- Internal air regulator pressure setting of 40 psi.
- Medium foam consistency.

Injection rates will vary if above settings are not used.



OPERATING INSTRUCTIONS

1. With the discharge ball valve (item# 38) closed, open the air inlet valve (item# 22).
2. Carefully open the discharge ball valve (item# 38).
3. Adjust the wet foam/dry foam valve (item# 27) to the desired wetness or dryness of foam using the steps below:
 - A. Close the valve completely in the clockwise direction.
 - B. Open the valve in the counter-clockwise direction 2-3 turns.
 - C. With the unit running, turn the valve counter-clockwise in 1/4 turn increments until the desired foam consistency is achieved.
 - D. If the valve is open too far, it can cause the pump to stall. If this happens, begin again with step A.
4. Replace pvc cover onto the control box after unit is properly adjusted.

ACCEPTABLE PRODUCTS

- Alkaline Cleaners
- Caustic Cleaners
- Sanitizers
- Mild Acids

UNACCEPTABLE PRODUCTS

- Strong Acids
- All Hydrocarbons
- D-Limonene

TROUBLESHOOTING

1. Check for proper air pressure (60 psi or more into the unit, 40 - 60 psi on internal air gauge (item# 19)).
2. Check air inlet filter bowl (item# 25) for debris such as water, oil, or rust particles. Press up on the bottom of the filter bowl to remove liquid.
3. Check for plugged strainer on chemical intake line. Replace if necessary, **strainer must be used**.
4. If the wet foam/dry foam valve (item# 27) is open too far, the pump may not cycle properly due to lack of air pressure. If this occurs, refer to operating instruction # 3.
5. Make sure proper foaming chemical and concentration is being used.
6. Make sure the proper metering tip is installed and not plugged. (See chart on previous page).
6. If air passes through the pump (item# 2) without cycling, replace pump.
7. If foam solution backs up into the air bowl (item# 25), the check valve (item# 29) needs to be replaced.
8. If foam comes out wet no matter where the wet foam/dry foam valve is positioned, the check valve (item# 29) may be plugged, remove and inspect, replace if necessary.
9. If unit foams at reduced pressure:
 - A. Check the air supply to the unit. If pressure is low, turn the unit off until the compressor can catch up.
 - B. If the air supply is 60 psi or higher, check the internal air gauge (item# 19) which should read about 40 - 60 psi. If the gauge is much more or less than that, adjust the pressure by turning the knob on the top of the air pressure regulator (item# 18).

RETURNS: NO MERCHANDISE MAY BE RETURNED FOR CREDIT WITHOUT DEMA'S WRITTEN PERMISSION. RETURN MERCHANDISE AUTHORIZATION NUMBER REQUIRED IN ADVANCE OF RETURN.

WARRANTY: DEMA products are warranted against defective material and workmanship under normal use and service for one year from the date of manufacture. This limited warranty does not apply to any products which have a normal life shorter than one year or failure and damage caused by chemicals, corrosion, improper voltage supply, physical abuse, or misapplication. Rubber and synthetic rubber parts such as "o"-rings, diaphragms, squeeze tubing and gaskets are considered expendable and are not covered under warranty. This warranty is extended only to the original buyer of DEMA products. If products are altered or repaired without prior approval of DEMA, this warranty will be void.

Defective units or parts should be returned to the factory with transportation prepaid.

If inspection shows them to be defective, they will be repaired or replaced without charge, F.O.B. factory. DEMA assumes no liability for damages. Return merchandise authorization number, to return units for repair or replacement, must be granted in advance of return.