

DEMA BLEND CENTER MODEL: 681GAP-2

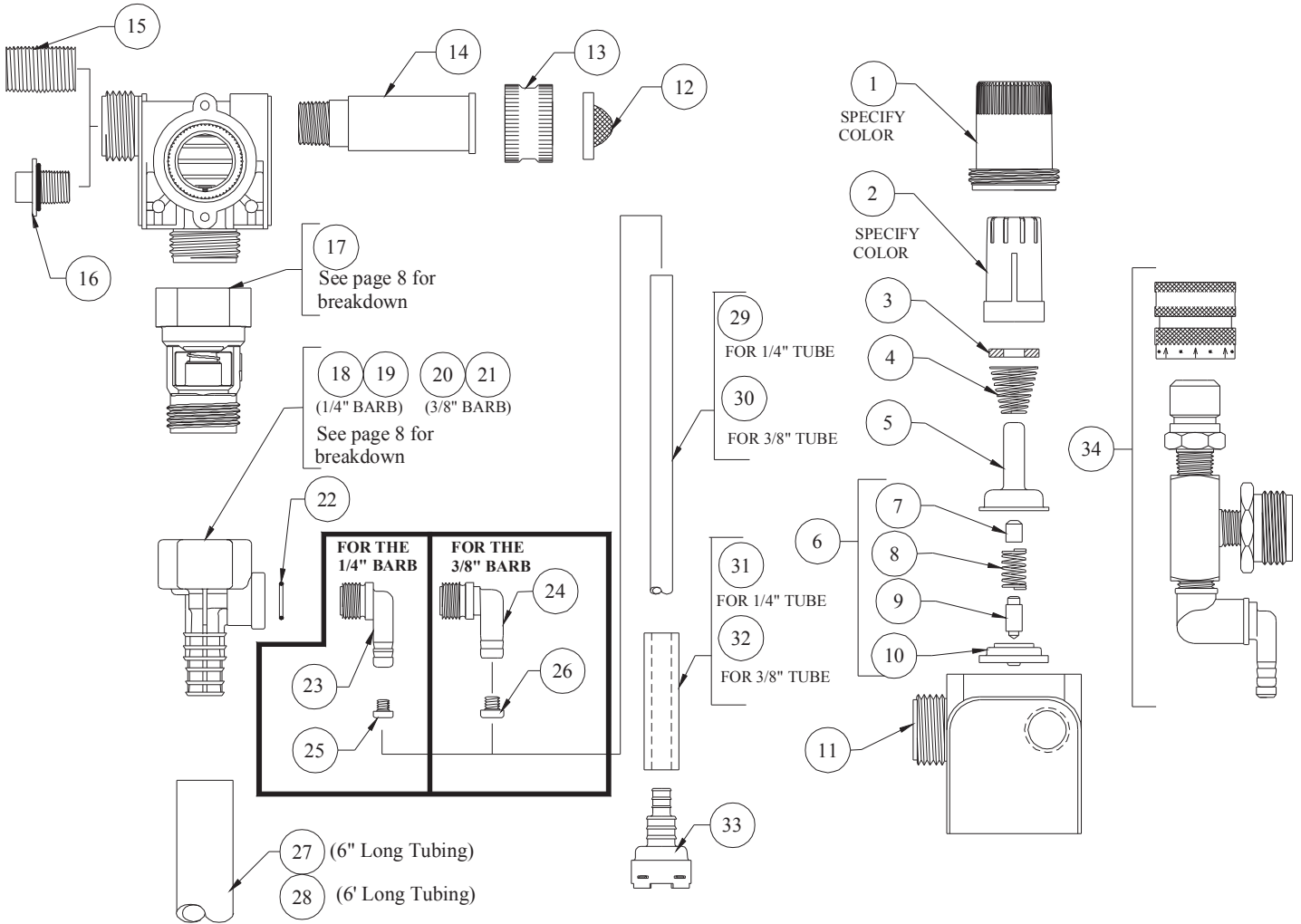

QTY.	PART NO.	DESCRIPTION
1	66-139	Magnet Housing (Specify Color)
2	66-140	Push Button (Specify Color)
3	63-35	Magnet
4	63-36	Spring
5	41-7-25	Enclosing Tube
6	63-87	Valve Repair Kit
7	63-37	Spacer
8	41-1-8	Kick-off spring
9	63-38	Plunger
10	41-15-5	Diaphragm
11	63-39	Valve Body
12	100-38	Strainer Washer
13	65-10-2	Coupling
14	65-14-2	Adapter Stem
15	66-31	Close Nipple
16	66-153	Pipe Plug & O-Ring Assy.
17	16-30	Action Gap Assembly

QTY.	PART NO.	DESCRIPTION
18	61-22GAP-2	4 GPM (1/4" Barb) Proportioner (Gray)
19	61-99GAP-2	1 GPM (1/4" Barb) Proportioner (Green)
20	61-22GAP-1	4 GPM (3/8" Barb) Proportioner (Gray)
21	61-99GAP-1	1 GPM (3/8" Barb) Proportioner (Green)
22	63-78	O-Ring
23	63-79	Inlet Barb (1/4" Barb)
24	63-80	Inlet Barb (3/8" Barb)
25	100-15K	Metering Tip Kit (14 Sizes) (1/4" Barb)
26	61-9K	Metering Tip Kit (15 Sizes) (3/8" Barb)
27	16-3-6	1/2" I.D. X 6" Lg. Vinyl Outlet Tube (1 GPM Only)
28	61-21	1/2" ID X 6' Lg. Vinly Outlet Tube (4 GPM Only)
29	100-12	1/4" ID X 8' Lg. Vinyl Supply Tubing
30	100-12L	3/8" ID X 8' Lg. Vinyl Supply Tubing
31	61-107-2	Ceramic Weight (1/4" ID Tube)
32	61-107	Ceramic Weight (3/8" ID Tube)
33	100-16E	Foot Valve

ACCESSORIES

QTY.	PART NO.	DESCRIPTION
34	68-6-QD2	Pressure Indicating Tee