

DEMA SPRAY FOAM MODEL 294CTDM INSTALLATION INSTRUCTIONS

1. PARTS

- A. Foamer assembly
- B. Plastic tubing with strainer and ceramic weight
- C. Metering Tips (specified on order)
- D. Outlet hose 3/4" ID x 25' lg. (optional)
- E. Shutoff valve (optional)

2. INSTALLATION

- A. Mounting: Attach plastic tubing to detergent inlet barb and slide ceramic weight over tubing.
- B. Water inlet is 3/4" garden hose swivel.
- C. Air inlet is 1/4" NPT
- D. Foam outlet is 3/4" garden hose. Connect shutoff valve to end of hose. See Table 1 for hose limitations.

Table 1		
Hose Size and Length	Minimum Pressures	
	Water	Air
25' of 3/4" ID	40 psi	40 psi
50' of 3/4" ID	50 psi	40 psi
25' of 1/2" ID	60 psi	40 psi

Table 2				
Viscosity (cps)	1	75	200	500
Maximum (Oz/Gal)	34.3	20.4	10.5	6.5

Table 3				
Pressure (psi)	40	50	60	80
Water Flow (G.P.M.)	1.4	1.6	1.7	2.0
Air Flow (SCFM)	3.5	4.2	4.8	6.1

3. OPERATION

WARNING: USE CARE WHEN HANDLING HAZARDOUS CHEMICALS.

Open shutoff valve at end of hose. Turn on air supply; set pressure at 40 psi. Turn on water supply.

4. ADJUSTMENT

Chemical feed rates are controlled by metering tips screwed into the detergent inlet barb. Tips are identified by number or color. Other tips are available from Dema (Part No. 61-9-specify size). To increase dryness of foam, raise air pressure 5 psi. Repeat if necessary.

5. SERVICING

CAUTION: TURN OFF AIR AND WATER SUPPLIES BEFORE SERVICING

If flow surges and unit fails to make foam:

- A. Is the outlet hose too small or too long?
- B. Is there sufficient water and air pressure? At least 30 psi is required.
- C. Does detergent contain a foaming agent?
- D. Is the foamer outlet attached to a manifold with too few or too small nozzles? They should have a combined water rating of 20 G.P.M. @ 40 psi.

If unit stops operating:

- A. Is the foot strainer clogged? Lift from drum and clean.
- B. Is the detergent check valve clogged? Remove the (4) screws in the square knob. Remove knob to inspect and clean check valve ball, spring, and o-ring.
- C. Is the metering tip clogged? Remove from inlet barb and clean.

DEMA SPRAY FOAM MODEL 294CTDM INSTALLATION INSTRUCTIONS

Table 4								
Metering Tip Color	Induction Rates for Viscosities Shown							
	1 cps		75 cps		200 cps		500 cps	
	Oz/Gal	Ratio	Oz/Gal	Ratio	Oz/Gal	Ratio	Oz/Gal	Ratio
Clear	0.84	152-1	0.65	197-1	0.45	284-1	0.30	427-1
Purple	1.35	95-1	1.10	116-1	0.90	142-1	0.60	213-1
Yellow	2.40	53-1	2.00	64-1	1.50	85-1	1.10	116-1
Green	4.20	30-1	3.40	38-1	2.65	48-1	2.10	61-1
Pink	5.25	24-1	4.50	28-1	3.45	37-1	2.60	49-1
Turquoise	9.40	14-1	7.25	18-1	5.45	23-1	3.70	35-1
Black	11.75	11-1	8.80	15-1	6.35	20-1	4.20	30-1
Gray	14.50	9-1	10.80	12-1	7.75	17-1	4.75	27-1
Red	18.00	7-1	13.20	10-1	8.30	15-1	5.00	26-1
Blue	20.60	6-1	14.70	9-1	8.65	14.8-1	5.20	25-1
Brown	24.10	5-1	16.15	8-1	9.30	14-1	5.50	23-1
White	27.50	4.7-1	17.80	7-1	9.70	13-1	5.70	22-1
Orange	30.00	4.3-1	18.50	6.9-1	10.10	12.7-1	5.85	21.9-1
Lt. Blue	32.00	4-1	18.90	6.8-1	10.20	12.5-1	6.00	21-1
Tan	32.50	3.9-1	19.25	6.6-1	10.40	12.3-1	6.25	20.5-1
None	34.25	3.7-1	20.45	6-1	10.60	12-1	6.50	20-1

All induction rates are based on 40 psi water pressure and 40 psi air pressure.

RETURNS: NO MERCHANDISE MAY BE RETURNED FOR CREDIT WITHOUT DEMA'S WRITTEN PERMISSION. RETURN MERCHANDISE AUTHORIZATION NUMBER REQUIRED IN ADVANCE OF RETURN.

WARRANTY: DEMA products are warranted against defective material and workmanship under normal use and service for one year from the date of manufacture. This limited warranty does not apply to any products which have a normal life shorter than one year or failure and damage caused by chemicals, corrosion, improper voltage supply, physical abuse, or misapplication. Rubber and synthetic rubber parts such as "o"- rings, diaphragms, squeeze tubing and gaskets are considered expendable and are not covered under warranty. This warranty is extended only to the original buyer of DEMA products. If products are altered or repaired without prior approval of DEMA, this warranty will be void.

Defective units or parts should be returned to the factory with transportation prepaid. If inspection shows them to be defective, they will be repaired or replaced without charge, F.O.B. factory. DEMA assumes no liability for damages. Return merchandise authorization number, to return units for repair or replacement, must be granted in advance of return.

SPRAY FOAM-MODEL 294 CDM & 294CTDM

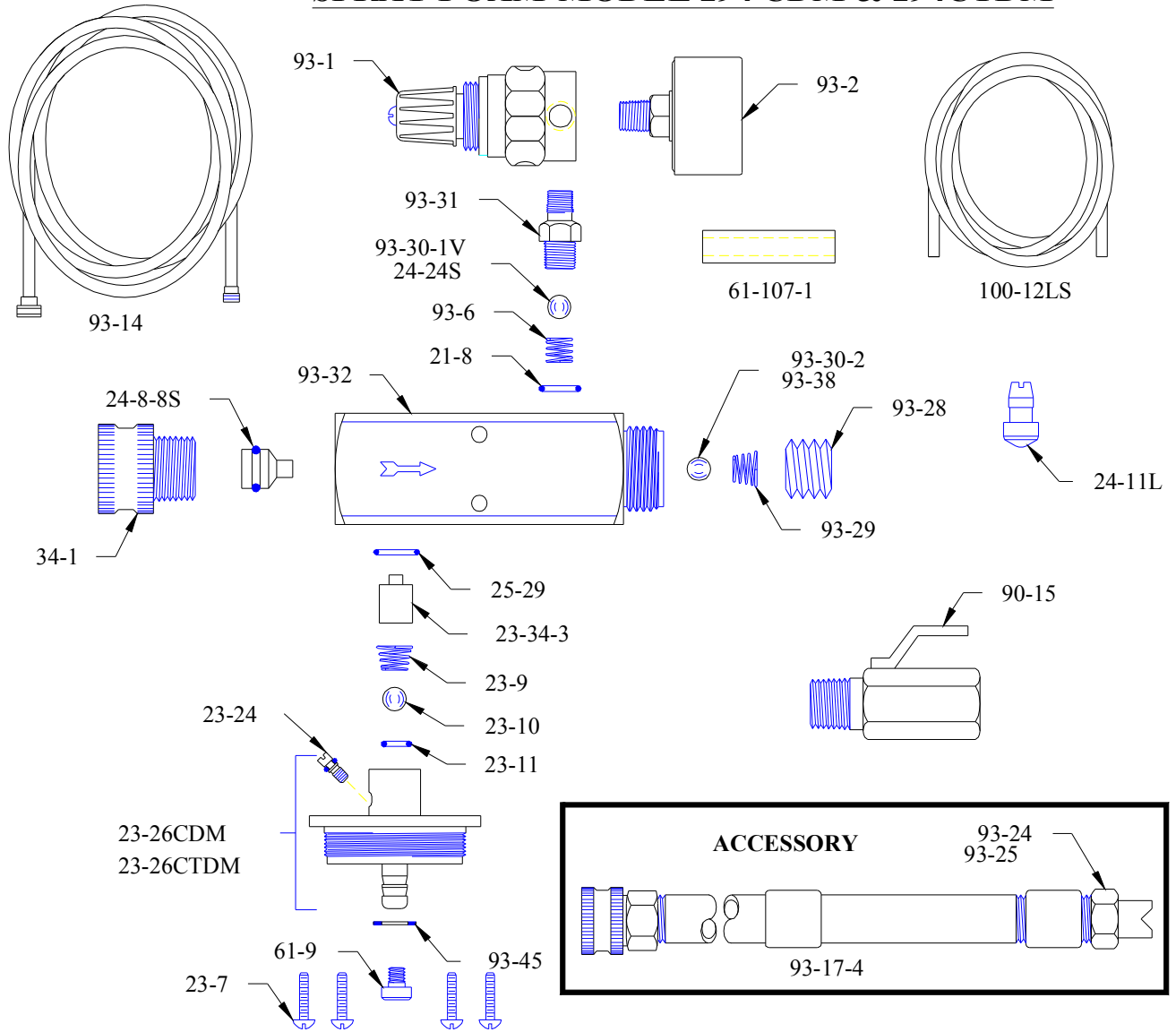

PART NO.	DESCRIPTION	PART NO.	DESCRIPTION
21-8	AIR CHECK VALVE O-RING	93-1	PRESSURE REGULATOR
23-7	MACHINE SCREW (4 REQD)	93-2	PRESSURE GAGE
23-9	CHECK VALVE SPRING	93-6	AIR CHECK VALVE SPRING
23-10	CHECK VALVE BALL (9/32 DIA STNLS. STL.)	93-14	3/4" ID X 25' LG. OUTLET HOSE
23-11	CHECK VALVE O-RING	93-28	RETAINER SCREW
23-24	METERING SCREW W/ O-RING (294CDM ONLY)	93-29	SPRING
23-26CDM	METERING KNOB & BUNG ASSEMBLY (294 CDM ONLY)	93-30-1V	BALL 1/4 DIA
23-26CTDM	METERING KNOB & BUNG ASSEMBLY (294 CDM ONLY)	93-30-2	BALL 5/16" DIA
23-34-3	CHECK VALVE CORE	93-31	ADAPTER
24-8-8S	WATER NOZZLE W/ O-RING	93-32	FOAMER BODY
24-11L	FOOT STRAINER	93-38	STAINLESS STEEL BALL 5/16" (294CDMT ONLY)
24-24S	STAINLESS STEEL BALL 1/4" (294CDMT ONLY)	93-45	SNAP RING
24-63	CHECK VALVE REPAIR KIT	100-12LS	1/2" OD VINYL TUBING X 8'3 1/2' LG.
25-29	METERING KNOB O-RING		
30-2V	BALL 5/16" RUBBER		
34-1	INLET HOSE ADAPTER		
61-9	METERING TIP-SPECIFY COLOR (294CDMT ONLY)		
61-107-1	CERAMIC WEIGHT		
90-15	OUTLET SHUTOFF VALVE		
			ACCESSORIES
		93-17-4	4' LG. SPRAY WAND W/ SOLID STREAM NOZZLE
		93-24	NOZZLE W/ SOLID STREAM (SUPPLIED)
		93-25	NOZZLE W/ 40° ANGLE