

Repair Kits

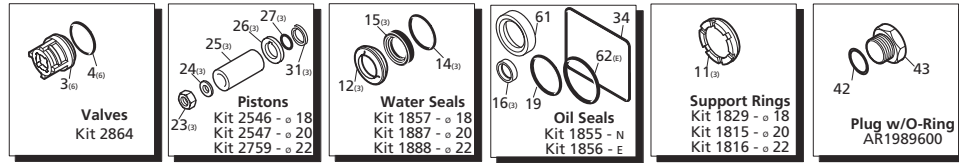

Special Parts / Kits

Code	Description	Qty
2809	Viton water seals ø18	1
2810	Viton water seals ø20	1
2811	Viton water seals ø22	1
42213	Kit for up to 180° F ø18 High Temp	1
2820	Kit for up to 180° F ø20 High Temp	1
1837	Rail Kit 5/8" - 2 Rails & 4 Bolts (N only)	1
2633	Rail Kit 1-3/4" - 2 Rails & 4 Bolts (N only)	1
2633H	Rail Kit 2-5/8" - 2 Rails & 4 Bolts (N only)	1
42149	Single Cylinder Piston Kit ø18	1

Pos	Code	Description	Qty	Pos	Code	Description	Qty	Pos	Code	Description	Qty	
1	960160	O-Ring ø17.86x2.62	6	30	1383020	Con rod - Bronze > 3000 PSI	3	61	621170	Oil seal	1	
2	960090	Valve cap - Brass	(478 in/lbs) 6	31	1383050	Con rod - Aluminum < 3000 PSI	3	62	1380220	O-Ring ø72.75x1.78	1	
3	960850	Valve cap - SS	(478 in/lbs) 6	32	1780510	O-Ring	1	63	1380210	Compete cover	1	
4	1380740	Valve cap - NP	(478 in/lbs) 6	33	1789010	Complete cover	1	64	1591	Electric Flange F17	1	
5	960090T	Valve cap - 1/4" threaded - Brass	(478 in/lbs) 1	34	1343510	Bolt M6x14	(89 in/lbs) 6	65	620610	Bolt	4	
6	960850T	Valve cap - 1/4" threaded - SS	(478 in/lbs) 1	35	2280100	Crankshaft 24mm	1	69	1381850	Washer	8	
7	1389051	Complete valve	6	36	2280090	Crankshaft 24mm	1		1389270	Complete pump head - Brass	ø18 1	
8	880830	O-Ring ø15.54x2.62	6	37	2280070	Crankshaft 24mm	1		1389272	Complete pump head - NP	ø18 1	
9	880581	Plug 1/4" G - Brass	2	38	2280060	Crankshaft 24mm	1		1389271	Complete pump head - NP	ø18 1	
10	1380690	Plug 1/4" G NP	2	39	2280110	Crankshaft 24mm - NL	1		1389208	Complete pump head - Brass	ø20 1	
11	820510	O-Ring ø10.82x1.78	2	40	1380520	Key	1		1389212	Complete pump head - NP	ø20 1	
12	960110	Support ring	ø18 3	41	180340	Oil seal	1		1389268	Complete pump head - Brass	ø22 1	
13	840300	Support ring	ø20 3	42	1380120	Shim 0.10 mm	1-3		1389269	Complete pump head - NP	ø22 1	
14	840320	Support ring	ø22 3	43	1380130	Shim 0.20 mm	1-3		75	1080401	Back-up ring	3
15	1382740	High pressure packing	ø18 3	44	1380530	Shim 0.25 mm	1-3		77	840370	Bearing	1
	840290	High pressure packing	ø20 3	45	1382810	Shim 0.05 mm	1-3		86	1260250	Oil sight glass	1
	840330	High pressure packing	ø22 3	46	1380040	Open bearing support	(217 in/lbs) 1		87	1260430	Snap ring	1
	1380090	Piston guide	ø18 3	47	740290	O-Ring ø14x1.78	3		88	1780690	Contrast disc	1
	1380150	Piston guide	ø20 3	48	1980740	Plug 3/8" G	2		89	1140450	O-Ring ø20.24x2.62	1
	1380160	Piston guide	ø22 3	49	1260470	Bolt M8x10	4			AR64516	Oil	1
	961240	O-Ring ø31.47x1.78	3	50	1380141	Rail 5/8"	(N Version only) 2				OIL CAPACITY - 15 OZ	
	880330	Low pressure seal	ø18 3	51	Z-Bracket 1-3/4	Rail 1-3/4"	(N Version only) 2					
	840280	Low pressure seal	ø20 3	52	Z-Bracket	Rail 2-5/8"	(N Version only) 2					
	840340	Low pressure seal	ø22 3	53	1980740	Plug 3/8" G	1					
	1383130	Oil seal	3	54	1981180	Plug 3/8" G NP	1					
	850370	Bolt M8x16	(217 in/lbs) 8	55	180101	O-Ring ø17.5x2	1					
	1380050	Closed bearing support	1	56	820361	Plug 1/2" G	1					
	640030	O-Ring ø59.99x2.62	2	57	960870	Plug 1/2" G NP	1					
	2280240	Bearing	1	58	1381071	Pump head - Brass	ø18 1					
	1382770	Pump housing	1	59	1381070	Pump head - NP	ø18 1					
	880130	Vented oil cap	1	60	1380020	Pump head - Brass	ø20 1					
	962010	Nut M8	(106 in/lbs) 3		1380680	Pump head - NP	ø20 1					
	962000	Washer ø8.1	3		1383010	Pump head - Brass	ø22 1					
	1380940	Ceramic piston	ø18 3		1383310	Pump head - NP	ø22 1					
	1380930	Ceramic piston	ø20 3		820150	Head bolt M8x70	(217 in/lbs) 8					
	1382360	Ceramic piston	ø22 3		2280260	Hollow shaft ø1-1/8"	1					
	1380950	Slinger	3		2280200	Hollow shaft ø1-1/8"	1					
	600180	O-Ring ø7.66x1.78	3		2280270	Hollow shaft ø1-1/8"	1					
	1380920	Guiding piston	3		2280280	Hollow shaft ø1-1/8"	1					
	1380060	Piston pin	3		1380320	Bearing	1					

Legend

ø 18	ø 18	ø 20	ø 22
For ○	For ●	For ■	For ▨
RKA3.5G22	RKA4G20	RKA5.5G13	RKA6.5G13
RKA3.5G25	RKA4G30A	RKA5.5G20H	RKA6.5G20H
RKA3.5G30H	RKA4G30	RKA5.5G26H	
RKA3.5G40H	RKA4G30H	RKA5.5G30H	
	RKA4G35H		For ★
	RKA4G40H		RKA7G13
			RKA7G20H
For □			
RKA4.5G17			
RKA4.5G25H	For ◆		
RKA4.5G30H	RKA4G35NL		
RKA4.5G35H			
RKA4.5G40H			
○ NP Over 3600psi			