

These are reference #'s ; Please call for additional part # assistance

- *1 SHAFT
- 2 IMPELLER
- 3 NUT, IMPELLER
- *3A COTTER PIN
- 4 WASHER, IMPELLER
- 5 KEY, IMPELLER
- *6 BEARING, GREASE THRUST
- *6A BEARING, OIL THRUST
- *7 BEARING, GREASE RADIAL
- *7A BEARING, OIL RADIAL
- 8 HOUSING, GREASE THR. BRG.
- 8A HOUSING, OIL THR. BRG.
- *9 LIP SEAL OUTBRD
- *10 SNAP RING, SHAFT
- *11 SNAP RING, HOUSING
- *12 LIP SEAL INBRD
- 13 FRAME, GREASE BRG.
- 13A FRAME, OIL BEARING
- 14 FITTING, GREASE (2)
- 14A FITTING, GREASE
- 15 BOLT, ADJUSTING (6)
- 16 LOCK NUT, HEX (3)
- 18 LOCKWASHER (3)
- 19 KEY COUPLING
- 20 SLINGER
- 21D HEAD, DOUBLE SEAL
- 21P HEAD, PACKING BOX
- 21S HEAD, SINGLE SEAL
- *22 PACKING
- *23 LANTERN RING
- 24 SLEEVE, SPRING SPCR.
- *24S MECH. SEAL, SINGLE
- *24D MECH. SEAL, DOUBLE
- 25 GLAND, PACKING
- 26 STUD, ST.BX. (2)
- 27 HEX NUT, STUD (2)
- 27A WASHER, STUD (2)
- 27B LOCKWASHER (2)
- 51 CASING
- *54 GASKET, CASE
- 55 BOLT, CASING (8)
- 56 CASE ADAPTOR
- *57 GASKET, HEAD
- *58 GASKET, DBL. GLAND
- 59 GLAND, DBL. & T9
- 60 BOLT, DBL. GLAND (4)
- 61 LOCK WASHER, GLAND (4)
- 62 LOCK WASHER, HEAD (4)
- 63 BOLT, TOP HEAD (2)
- 64 BOLT, BOTTOM HEAD (2)
- 81 PLUG, PIPE, 1/8"NPT
- 82 PLUG, PIPE, 1/4"NPT
- 92 BREATHER, OIL
- 93 SIGHT GLASS, OIL
- *95 O RING, THR. BRG. OIL
- 96 NAME TAG, SERIAL
- 97 DRIVE PINS (2)

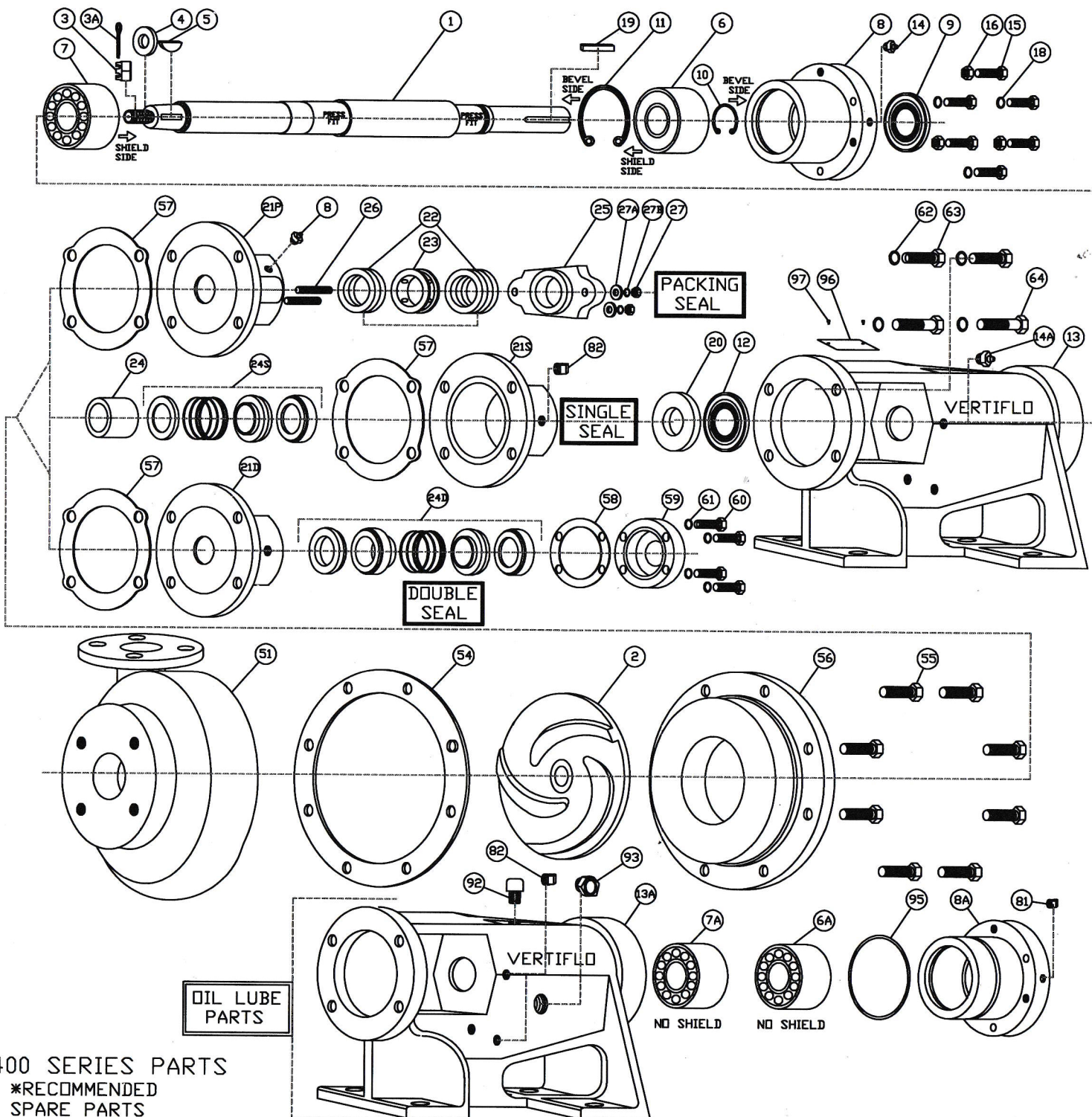

1400 SERIES PARTS
***RECOMMENDED**
SPARE PARTS