

MAX FLOW  
MAX PRESSURE  
RATED PUMP SPEED  
POWER REQUIREMENT  
LUBRICATION

5.5 GPM / 20 L/MIN  
3675 PSI / 250 BAR  
1450 RPM  
13.0 HP ELECTRIC  
16 OZ UDOR LUBE

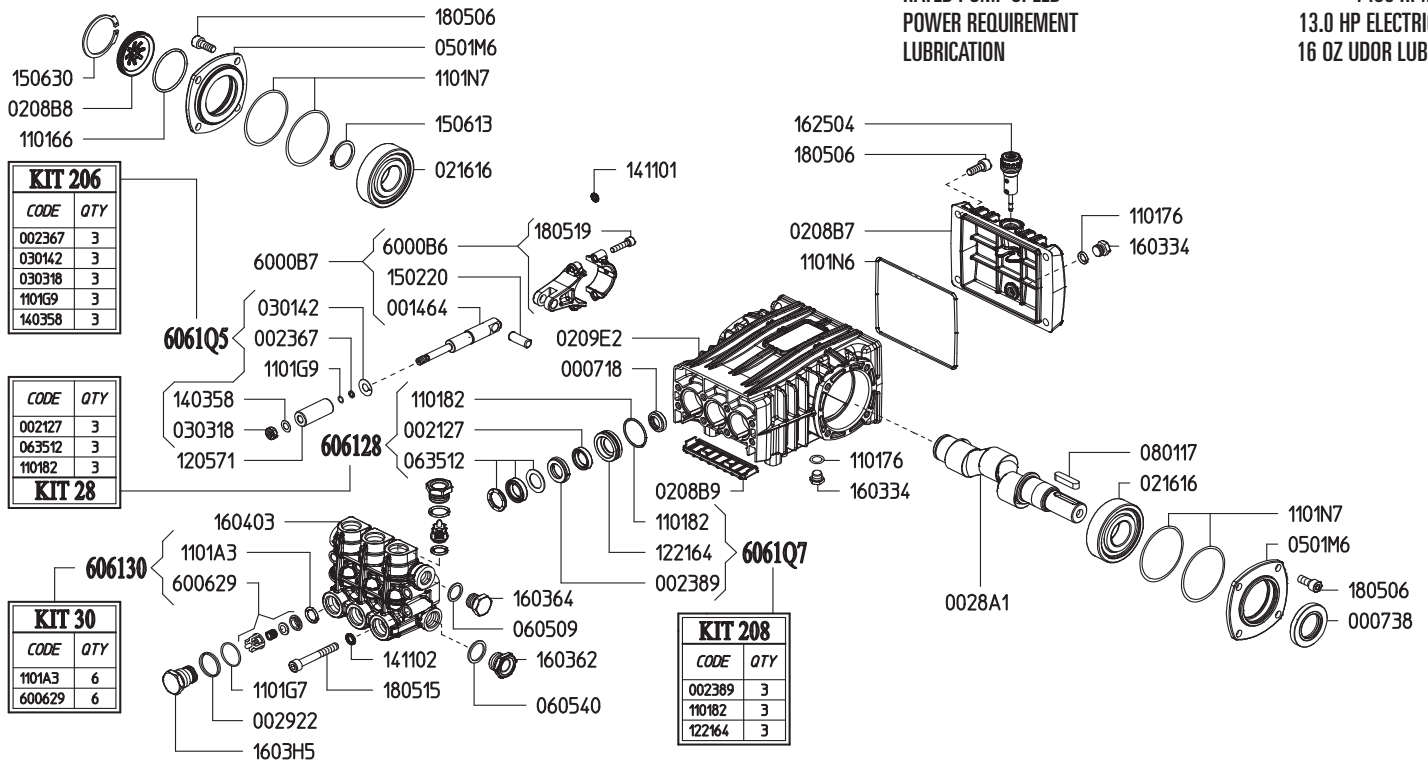

Part #	Description	Qty
0007.18	OIL SEAL D15X24X5	3
0007.38	OIL SEAL D30	1
0014.64	PLUNGER GUIDE "B/BK"	3
0021.27	WATER SEAL LP D18 <sup>B</sup>	3
0023.67	RING D5.2X8X1.3 <sup>C</sup>	3
0023.89	UPPER RING D18 "B/BK" <sup>D</sup>	3
0028.A2	MALE SHAFT "B/BK" D24	1
0029.22	RING "CK" D15.2	6
0208.B7	BACK COVER "B/BK"	1
0208.B8	COVER "B/BK"	1
0208.B9	COVER "B/BK"	1
0209.E2	CRANKCASE "B-X/BK-X"	1
0216.16	ROLLER BEARING D30	2
0301.42	DISC <sup>C</sup>	3
0303.18	NUT M8XH5 <sup>C</sup>	3
0501.M6	BEARING FLANGE "B/BK"	2
0605.09	GASKET D17X23X1.5	1
0605.40	GASKET D21.5X27X1.5	1
0635.12	HIGH PRESSURE SEAL KIT D18 <sup>B</sup>	3
0801.17	KEY A8X7X35 UNI6604	1
1101.66	O-RING D44.12 (RIF.3175)	3
1101.76	O-RING D9.13 (RIF.109)	1
1101.82	O-RING D31.47X1.78 (RIF 2125) <sup>B D</sup>	2
1101.A3	O-RING D13.9X2.62 (RIF 3056) <sup>B</sup>	3
1101.G7	O-RING D15.08 (RIF.119) 90SHORE	6
1101.G9	O-RING D4.48 (RIF 2018) <sup>C</sup>	6
1101.N6	O-RING D126.67 (RIF 3500)	1

Part #	Description	Qty
1101.N7	O-RING D68	4
1205.71	CERAMIC PLUNGER D18 "B/BK"	3
1221.64	PRESSURE RING D18 "B/BK" <sup>D</sup>	3
1403.58	WASHER D8 <sup>C</sup>	3
1411.01	SCHNOOR WASHER D6	6
1411.02	SCHNOOR WASHER D8	8
1502.20	PIN D10X27	3
1506.13	SNAP RING D30	1
1506.30	SNAP RING D52	1
1603.34	PLUG G1/4	2
1603.62	PLUG G1/2	1
1603.64	PLUG G3/8	1
1603.H5	VALVE PLUG "BK"	6
1604.03	HEAD "BK-X"	1
1625.04	OIL PLUG G3/8	1
1805.06	ALLEN SCREW M8X20 UNI 5931	8
1805.15	ALLEN SCREW M8X60 UNI 5931	8
1805.19	ALLEN SCREW M8X25 UNI 5931	6
6000.B6	ROD ASSY "B/BK"	3
6006.29	VALVE ASSY WITHOUT O-RING <sup>B</sup>	6
6061.28	KIT 28 - WATER SEAL KIT	
6061.30	KIT 30 - VALVE KIT "BK"	
6061.Q5	KIT 206 - PLUNGER KIT D15/18 "B/BK"	
6061.Q7	KIT 208 - BRASS RING KIT D18 "B/BK"	

<sup>B</sup> Parts in 6061.30 (Kit 30).

<sup>B</sup> Parts in 6061.28 (Kit 28).

<sup>C</sup> Parts in 6061.Q5 (Kit 206).

<sup>D</sup> Parts in 6061.Q7 (Kit 208).