

ACCUFLOW HP REPLACEMENT PARTS

063-0173-292 (TWO VALVE SYSTEM)
 063-0173-293 (FAST VALVE SYSTEM)

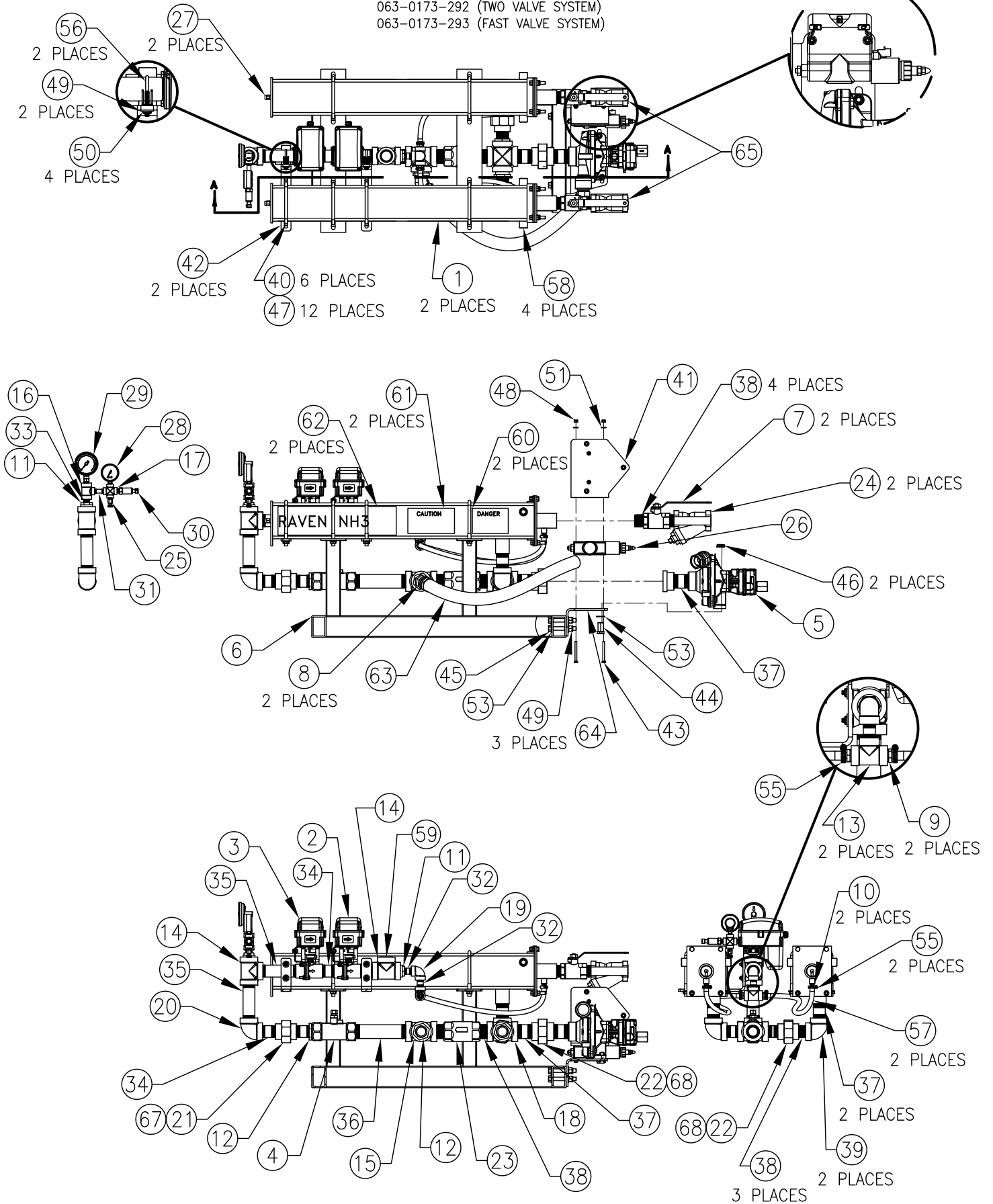

SECTION A-A

ACCUFLOW HP REPLACEMENT PARTS

063-0173-292 (TWO VALVE SYSTEM)
063-0173-293 (FAST VALVE SYSTEM)

2	GASKET, 1-1/2 UNION	219-0000-156		NOT SHOWN	68
1	GASKET, 1-1/4 UNION	219-0000-027		NOT SHOWN	67
1	*FAST VALVE, 1-1/4" NPT	063-0173-204		NOT SHOWN	66
1	CAP, PLUG, TAPERED	118-0159-053	1-1/2" NPT		65
1	BRACKET, HP ACCUFLOW, PUMP SUPPORT	107-0171-917			64
1	HOSE, NH3	214-0001-043	1-1/4" x 27"		63
2	LABEL, NH3 SUPER COOLER	039-0159-059			62
2	LABEL, CAUTION, NH3	039-0159-035			61
2	LABEL, DANGER, NH3	039-0159-034			60
1	CAP, PLUG, TAPERED	118-0159-052	1-1/4" NPT		59
4	CAP, PLUG, TAPERED	118-0159-017	1/2" NPT		58
50"	TUBING, PLASTIC EVA	214-0001-002		CUT 2@25"	57
2	CLAMP, MUFFLER	435-3003-030	1-1/2"	13±2 FT-LBS	56
4	CLAMP, HOSE, WORM DRIVE	435-3003-002			55
6	WASHER, FLAT	313-2300-018	1/2		54
2	WASHER, FLAT	313-2300-014	3/8		53
4	WASHER, FLAT	313-2300-013			52
2	WASHER, FLAT	313-2300-010	1/4		51
4	WASHER, SPLIT LOCK	313-1000-019	5/16		50
3	NUT, LOCK, NYLON INSERT	312-4000-101	1/2-13 UNC		49
2	NUT, LOCK, NYLON INSERT	312-4000-057	1/4-20 UNC		48
12	NUT, FLANGE LOCK	312-1001-165	7/16-14 UNC	30±5 FT-LBS	47
2	NUT, FLANGE LOCK	312-1001-164	3/8-16 UNC		46
3	BOLT, MACHINE, HEX HEAD	311-0058-105	1/2-*13 UNC-2 x 3-1/2"		45
2	BOLT, MACHINE, HEX HEAD	311-0054-106	3/8-16 UNC-2 x 1-1/4"		44
2	BOLT, MACHINE, HEX HEAD	311-0050-112	1/4-20 UNC-2 x 2-3/4"		43
1	BRACKET, MOUNTING, VALVE, HP ACCUFLOW	107-0171-931			42
1	BRACKET, HP ACCUFLOW, NODE SUPPORT	107-0171-918			41
6	U-BOLT	107-0171-603	5-1/16"Wx6"Lx7/16"-14 UNC		40
2	ELBOW, PIPE, 90°	333-0005-007	1-1/2"		39
2	NIPPLE, PIPE	333-0008-047	1-1/2" x 2"		38
1	NIPPLE, PIPE	333-0008-049	1-1/2" x 3"		37
1	NIPPLE, PIPE	333-0008-052	1-1/2" x 8"		36
2	NIPPLE, PIPE	333-0008-042	1-1/4" x 6" L		35
4	NIPPLE, PIPE	333-0008-040	1-1/4" x 3" L		34
1	NIPPLE, PIPE	333-0008-015	1/2" x 1-1/2" L		33
1	NIPPLE, PIPE	333-0008-016	1/2" x 2" L		32
1	NIPPLE, PIPE	333-0008-002	1/4" x 2" L		31
1	TRANSDUCER, PRESSURE	422-0000-090	0-250 PSI		30
1	GAUGE, TEMPERATURE	417-0001-009	25-125° F		29
1	GAUGE, PRESSURE	417-0001-008	0-150 PSI		28
2	VALVE, HYDROSTATIC RELIEF	334-0002-005	1/4", 350 PSI		27
1	VALVE, BRAND, PWM	334-0001-042			26
1	BLEED VALVE	334-0001-012	1/4" NPT		25
2	NH3 STRAINER, Y-TYPE, 1-1/2"	063-0173-312			24
1	VALVE, CHECK	333-0011-083	1-1/2", 1/2 PSI		23
2	UNION, PIPE	333-0006-006	1-1/2", CLASS 3000		22
1	UNION, PIPE	333-0006-005	1-1/4", CLASS 3000		21
1	ELBOW, PIPE	333-0005-006	1-1/4"		20
1	ELBOW, PIPE, 90°	333-0005-003	1/2"		19
1	CROSS, PIPE	333-0004-031	1-1/2"		18
1	CROSS, PIPE	333-0004-030	1/4"		17
1	TEE, PIPE	333-0004-009	1/2" x 1/2" x 1/4"		16
1	TEE, PIPE	333-0004-007	1-1/2"		15
2	TEE, PIPE	333-0004-006	1-1/4"		14
1	TEE, PIPE	333-0004-003	1/2"		13
1	BUSHING, PIPE	333-0003-019	1-1/2" x 1-1/4"		12
2	BUSHING, PIPE	333-0003-017	1-1/4" x 1/2"		11
2	FITTING, HOSE BARB	333-0002-004	1/4" HNPT x 3/8" HB		10
2	FITTING, HOSE BARB	333-0002-006	1/2" NPT x 3/8" HB		9
2	FITTING, FEMALE SWIVEL ADAPTER, 45°	333-0001-024	1-1/4"		8
2	MODIFICATION, 1-1/2" BALL VALVE	019-0159-571			7
1	WELDMENT, HP ACCUFLOW, MOUNTING FRAME	116-0159-702			6
1	PUMP, CENTRIFUGAL	416-1001-009			5
1	FLOWMETER, RFM 60S	063-0171-666			4
1	CONTROL VALVE	063-0173-202			3
1	ON/OFF VALVE, 1-1/4" NPT	063-0173-203			2
2	HEAT EXCHANGER, 1-1/2" PLUMBING	063-0173-290			1
QTY. REQ'D.	NOMENCLATURE OR DESCRIPTION	PART OR IDENTIFYING NO.	SPECIFICATION	MATERIAL OR NOTE	ITEM NO.

LIST OF MATERIALS OR PARTS LIST

054-0159-331
10/12 REV. C
SHEET 2 OF 2

* - ITEMS LISTED ARE NOT SHOWN