

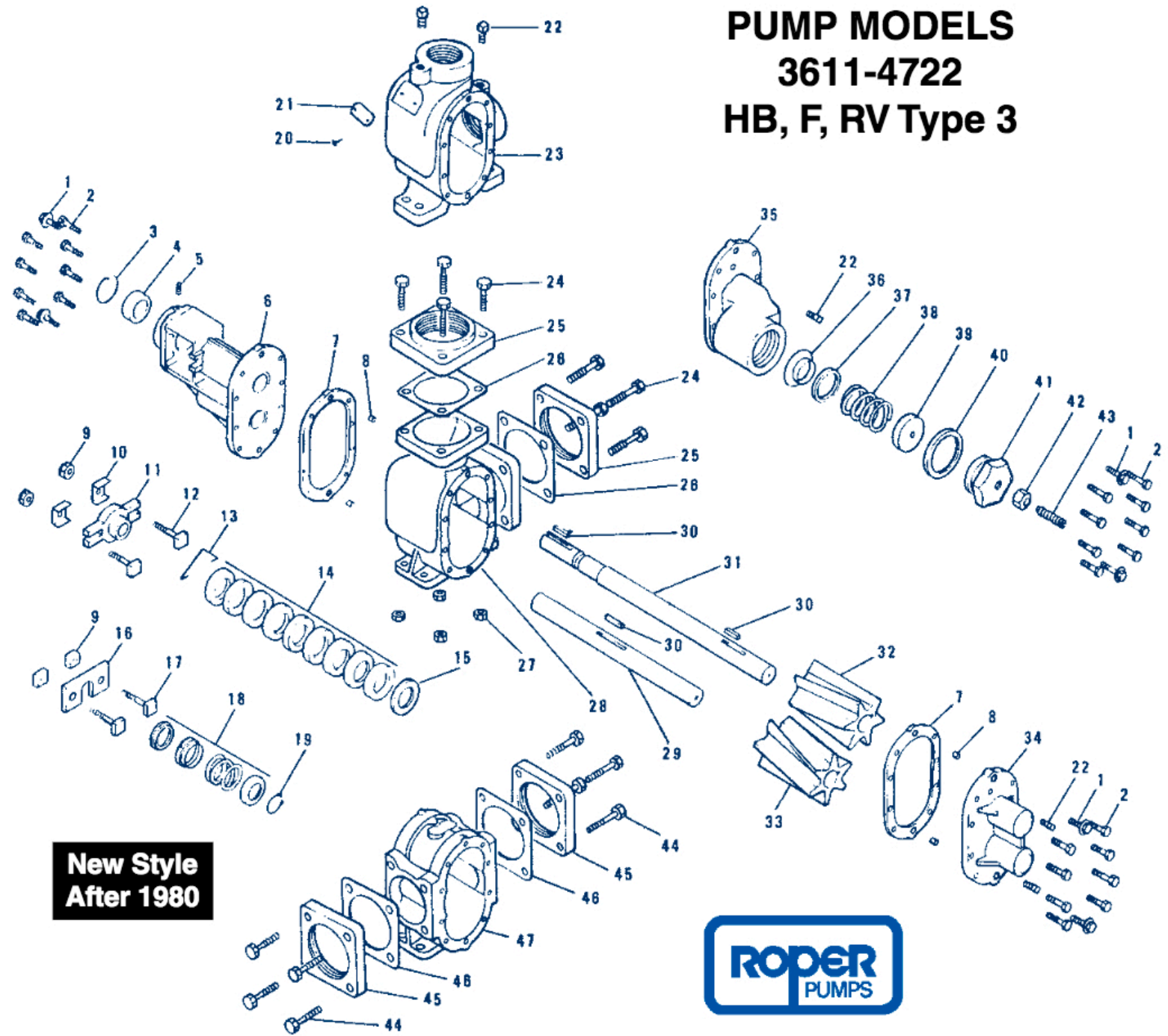

**WE MAINTAIN A LARGE  
INVENTORY OF ROPER  
PUMP REPAIR PARTS--  
SEE MANY PUMP PARTS &  
SCHEMATICS ON [dultmeier.com](http://dultmeier.com)**

**PUMP MODELS  
3611-4722  
HB, F, RV Type 3**



**New Style  
After 1980**



NO.	ON	DESCRIPTION	QTY	ORDER BY PART NUMBER BELOW		
				11	17	22
1	C	WASH, HD CAP SCREW	4	G49-24	G49-24	G49-24
2	C	HEX HD CAP SCREW	16	G49-037100	G49-037100	G49-037100
3	C	RETAINING RING	1	G41-10	G41-10	G41-10
4	C	BALL BEARING	1	G40-41	G40-41	G40-41
5	C	LUBE FITTING	1	G63-1	G63-1	G63-1
6	C	BACKPLATE ASSEMBLY	1	N2-403	N2-403	N2-403
		BEARING, LONG, BRONZE	1	G5-257	G5-257	G5-257
		BEARING, SHRT, BRONZE	1	G5-258	G5-258	G5-258
7	C	GASKET, CASE	2	D11-338	D11-338	D11-338
8	C	DOWEL PIN, HOLLOW	4	D48-34	D48-34	D48-34
9	C	LOCKNUT	2	D441-755	D441-755	D441-755
10	PB	CLIP, PKG GLAND	2	D42-1	D42-1	D42-1
11	PB	GLAND, PKG	1	P10-178	P10-178	P10-178
12	PB	SQUARE HEAD BOLT	2	G67-043275	G67-043275	G67-043275
13	PB	CLIP, SPRING	1	D42-2	D42-2	D42-2
14	PB	PACKAGE SET	1	N43-1	N43-1	N43-1
15	PB	WASHER, PACKAGE	1	G8-246	G8-246	G8-246
16	MS	RETAINER, SEAL	1	D23-252	D23-252	D23-252
17	MS	SQUARE HEAD BOLT	2	G67-043125	G67-043125	G67-043125
18	MS	MECH. SEAL, COMPLETE	1	G4-101	G4-101	G4-101
19	MS	RETAINING RING	1	G41-76	G41-76	G41-76
20	C	DRIVE SCREW	2	G62-9	G62-9	G62-9
21	C	NAMEPLATE	1	G12-34	G12-34	G12-34
22	C	PIPE PLUG		(4)G56-12	(4)G56-12	(2)G56-12
23	C	CASE	1	P1-178	P1-177	NA
24	C	HEX HD CAP SCREW	8	G49-050150	G49-050125	G49-062225
25	C	FLANGE, STRAIGHT	2	P23-30	P23-12	P23-10
26	C	GASKET, FLANGE	2	D11-333	D11-332	D11-90
27	C	NUT	8	NA	NA	G44-062
28	C	CASE	1	P1-401	P1-402	P1-175
29	C	SHAFT, IDLER	1	D1-1098	D1-1100	D1-1077
30	C	KEY	3	D30-9	D30-9	D30-9
31	C	SHAFT, DRIVE	1	D1-2072	D1-2073	D1-1998
32	C	GEAR, LH	1	P6-276	P6-274	P6-278
33	C	GEAR, RH	1	P6-275	P6-273	P6-277
34	C	FACEPLATE, ASSEMBLY, PL	1	N3-177	N3-177	N3-177
		BRG, BRZ	2	G5-257	G5-257	G5-257
35	C	FACEPLATE ASSEMBLY, RV	1	N3-200	N3-200	N3-200
		BEARING, BRONZE	2	G5-257	G5-257	G5-257
36	C	POPPET	1	D16-16	D16-16	D16-16
37	C	ADAPTER, POPPET	1	G8-281	G8-281	G8-281
38	C	SPRING, STD	1	G10-355	G10-355	G10-355
		SPRING, HIGH PRESSURE	1	G10-375	G10-375	G10-375
39	C	GUIDE, SPRING	1	D8-348	D8-348	D8-348
40	C	GASKET, CAP	1	D828-41	D828-41	D828-41
41	C	PLUG CAP	1	P17-110	P17-110	P17-110
42	C	NUT, LOCK, AND SEAL	1	G43-18	G43-18	G43-18
43	C	SCREW, ADJUSTING	1	G62-44	G62-44	G62-44
44	C	HEX HEAD CAP SCREW	8	G49-050150	G49-050175	G49-062225
45	C	FLANGE, STRAIGHT	2	P23-30	P23-35	P23-19
46	C	GASKET, FLANGE	2	D11-333	D11-332	D11-90
47	C	CASE, THROUGH-PORTS	1	P1-170	P1-181	P1-171

N7-250 COMPL RV FACEPLATE ASSY W/STD SPRING (35 THROUGH 43 INCL)

N7-406 COMPL RV FACEPLATE ASSY W/HIGH PRESS. SPRING (35 THROUGH 43 INCL)