

## Hydro Excavation Spray Gun - Inline Style -



**SUTTNER**

**Inline Trigger Activated Spray Gun** is ideal for hydro excavation or large volume cleaning. Impact resistant trigger guard and plated 1/2" FPT inlet and outlet ports. Rated to 16 GPM and 3200 PSI. Horizontal, inline, flow through design. Rated to 3200 PSI and 300° F.

Part No.	Style	Max. Flow	Max. Pressure
NP ST3232	Trigger	16 GPM	3200 PSI

## Hydro Excavation Spray Gun - Inline Style -

**Palm Activated Inline Spray Gun** is designed for hydro excavation and large volume wash down. 1/2" FPT Stainless steel inlet swivel and 1/2" FPT fixed outlet. Rated to 32 GPM and 4500 PSI. Comfortable ergonomic hand grip reduces fatigue. Rated to 4500 PSI and 212° F.

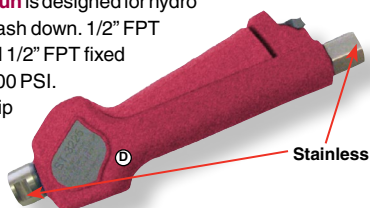

**SUTTNER**

Part No.	Style	Max. Flow	Max. Pressure
NP ST3240	Palm Style	32 GPM	4500 PSI

## Reverse Trigger Spray Wand



**Unique Reverse Trigger Spray Wand** is designed for the hydro excavation market. Much easier to use in vertical digging applications. Rated to 10.5 GPM and 5,000 PSI. Inlet is 3/8" FPT and outlet is 1/4" FPT. Temperatures to 320° F.

Part No.	Output
IP DCG5010HE Reverse Trigger Gun	10 GPM @ 5000 PSI

## Inline Spray Wand

**Food Grade Inline Spray Wand.** Ideal for foaming or rinse applications. Stainless steel construction with plastic cover. Ergonomic design reduces trigger pull by 40% and holding force by 90%. Can be locked in open position for extended use. 1/2" FPT swivel inlet x 1/2" FPT solid outlet.

Rated to 31 GPM & 870 PSI. Maximum temperature is 212° F.

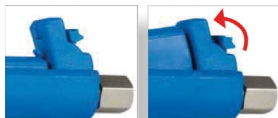

Can Be Locked in Opened Position

Part No.	Flow	Pressure	Wt.
NP ST3225 Inline Spray Wand	31 GPM	870 PSI	1.6 lbs.

Viton® is a registered trademark of DuPont Performance Elastomers

## High Flow Spray Wand

**SUTTNER**

**High Flow Spray Wand** from Suttner. Chemical resistant with stainless steel construction. Ideal for a range of applications including hydro excavation, soft wash, food grade rated. 1/2" ports with built in swivel inlet. Easy pull design reduces trigger force by up to 60%. Rated to 21 GPM, 1800 PS, 300° F.



Part No.	Flow	Pressure	Wt.
NP ST2320	21 GPM	1800 PSI	1.70 lbs

## High Flow Trigger Wands

**High Flow Trigger Wands** are ideal for hydro excavation and high gpm flow requirements. Ergonomic design minimizes fatigue.

**Regular Models** are rated to 195° F. **Inline Models** are rated to 250° F.



YG1732  
YG2953B  
ML210  
RL84



YG2527S &  
YG4032S  
Inline

Part No.	Max. Flow	Max. PSI	Ports
MV RL84	21 GPM	8100 PSI	1/2" FPT
IP YG1732	32 GPM	1750 PSI	1/2" FPT
IP YG2953B	53 GPM	2900 PSI	3/4" FPT
MV ML210	53 GPM	3200 PSI	3/4" FPT
IP YG2527S	* 27 GPM	2500 PSI	1/2" FPT
IP YG4032S	* 32 GPM	4000 PSI	1/2" FPT

\* Straight Inline Design.

## High Pressure Trigger Wand



**Trigger Spray Wand and Lances** rated to 10,000 PSI. 3/8" Inlet x 3/8" outlet ports. 250° F.



Part No.	Max. Flow	Max. PSI
MV ML710	16 GPM	10,150
MV L7031	3/8" x 31" Lance Extension with Handle	.....
MV L7047	3/8" x 47" Lance Extension with Handle	.....

## High Pressure Trigger Wand - Safety Orange -

**Suttner Easy Pull Trigger Spray Wand** with Safety Orange, impact-resistant housing. 60% Less trigger pull. Rated to 12 GPM. 5000 PSI, 300° F. Inlet is 3/8" FPT, outlet is 1/4" FPT.



**SUTTNER**

Part No.	Flow	Pressure
NP ST2305-O Easy Pull Spray Wand	12 GPM	5000 PSI

WE APPRECIATE YOUR

# BUSINESS!