



Wand Swivels



Easy Turn Gun Swivels for High Pressure Spray Wands are high quality, Swiss-Made, construction. Rated to 4000 PSI & 250° F. Nickel-plated brass body, stainless steel bearing. Available in 1/4" and 3/8" sizes in male thread, (MPT) and female thread, (FPT). Nitrile o-ring.

Part No.	Ports	Max. PSI
MM 32557	1/4" FPT x 1/4" FPT	4000
MM 32552	1/4" MPT x 1/4" FPT	4000
MM 32569	3/8" FPT x 3/8" FPT	4000
MM 32769	3/8" FPT x 3/8" FPT	7300
MM 32564	3/8" MPT x 3/8" FPT	4000
MM 32852	* 3/8" MPT x 3/8" FPT	4000
MM 32764	3/8" FPT x 3/8" FPT	7300
MM 32563	3/8" MPT x 3/8" MPT	4000
MM 32763	3/8" MPT x 3/8" MPT	7300
MM 32562	3/8" MPT x 1/4" FPT	4000
MM 32561	3/8" MPT x 1/4" MPT	4000
MM 32863	1/2" MPT x 1/2" MPT	4000
MM 32864	1/2" MPT x 1/2" FPT	4000
MM 32894	1/2" MPT x 1/2" FPT	7300

* 3/8" Flow Path.

CALL for CURRENT PRICING



Flanged Style High Pressure Swivels



High Quality, Flanged Style Swivels for surface cleaners, fire applicators, under carriage wash, etc. Brass, Nickel-plated construction. Standard with Carbide seals rated to 250° F.

Part No.	Ports	Max. PSI	Max. RPM	Maximum Temperature
MM 58051	1/4" F x 1/4" M	4000	2000	250° F.
MM 58153	3/8" F x 3/8" M	4000	2000	250° F.
MM 38051	1/4" F x 1/4" M	2000	2000	250° F.
MM 38153	3/8" F x 3/8" M	2000	2000	250° F.

Call Toll Free For Prices



Bulkhead Style High Pressure Swivels



High Quality, Bulkhead Swivels for surface cleaners, tire applicators, under carriage wash, etc. Brass, Nickel-plated construction. **37 Series** is standard with Ceramic seals. **57 Series** is standard with Carbide seals.

Part No.	Ports	Max. PSI	Max. RPM	Maximum Temperature
MM 33051	1/4" F x 1/4" M	4000	1000	100° F.
MM 33153	3/8" F x 3/8" M	4000	1000	100° F.
MM 37051	1/4" F x 1/4" M	2500	2000	250° F.
MM 37153	3/8" F x 3/8" M	2500	2000	250° F.
MM 57051	1/4" F x 1/4" M	4000	2000	250° F.
MM 57153	3/8" F x 3/8" M	4000	2000	250° F.

Call Toll Free For Prices

High Pressure Gun Swivels

High Pressure Gun Swivels. Brass or stainless steel construction. Rebuildable design. Rated to 200° F. Brass rated to 3,000 PSI. Stainless rated to 5,000 PSI.



7080

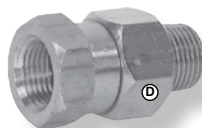

7044

Part No.	Material	Size	Max. PSI
AA 7045	Brass	3/8" F x F	3000
AA 7080	Brass	3/8" M x F	3000
AA 7044	Stainless	3/8" M x F	5000
AA 7084	Repair Kit for above swivels		

Best Seller



Inline Swivels

Inline Swivels from Mosmatic feature Swiss Engineering and are designed for high flow water and air applications. Buna seals are standard, but EPDM is available.

DGE Series feature Nickel-Plated Brass bodies, one bearing design. Rated to 4000 PSI and 250° F. Maximum of 30 RPM.

DGR Series feature Stainless Steel bodies, 4 Bearing design. Rated to 3000 PSI and 180° F. RPM varies with size.



DGE MxF



DGR FxF

DGE Series

Part No.	Ports	Construction	Max RPM
MM 34853	1/2" M x F	Nickel-Plated Brass	30
MM 34863	1/2" F x F	Nickel-Plated Brass	30
MM 34854	3/4" M x F	Nickel-Plated Brass	30
MM 34864	3/4" F x F	Nickel-Plated Brass	30
MM 34855	1" M x F	Nickel-Plated Brass	30
MM 34865	1" F x F	Nickel-Plated Brass	30
MM 34856	1-1/4" M x F	Nickel-Plated Brass	30
MM 34866	1-1/4" F x F	Nickel-Plated Brass	30
MM 34857	1-1/2" M x F	Nickel-Plated Brass	30
MM 34867	1-1/2" F x F	Nickel-Plated Brass	30

CALL for CURRENT PRICING

DGR Series

Part No.	Ports	Construction	Max RPM
MM 34211	1/2" M x F	Stainless Steel	200
MM 34212	1/2" F x F	Stainless Steel	200
MM 34311	3/4" M x F	Stainless Steel	150
MM 34312	3/4" F x F	Stainless Steel	150
MM 34411	1" M x F	Stainless Steel	130
MM 34412	1" F x F	Stainless Steel	130
MM 34511	1-1/2" M x F	Stainless Steel	100
MM 34512	1-1/2" F x F	Stainless Steel	100

CALL for CURRENT PRICING



Inline Swivels

PARKER PS Series Inline Swivels are designed to eliminate hose twist and torque that may cause premature hose failure. Ideal for hose reels, wash booms and industrial applications.



Standard Features: Sealed bearings and hardened bearing races for extended service life • Full flow design • Buna or Viton® seals • Teflon backup rings • (Chromium-6 Free) Plated carbon steel construction for added corrosion resistance • Rated to 5000 PSI and 250° F. (Up to 1" sizes) • Available in M x F or F x F NPT ports • Many other port options are available.

Male x Female

Part No.	Size	Seal	Max. PSI
PA PS6101	3/8" M x F	Buna	5000
PA PS8101	1/2" M x F	Buna	5000
PA PS12101	3/4" M x F	Buna	5000
PA PS16101	1" M x F	Buna	5000

Viton® is a registered trademark of DuPont Performance Elastomers

Order from our entire inventory online!
Scan our QR Code dultmeier.com



- Current Pricing
- Web Specials
- Closeout Items
- Current Flyers
- Order Status
- Parts Schematics

