



Nylon Swivels



QJ8600-1/4NYB
Nylon Single Swivel
1/4" FPT x QuickJet

Maximum Temperature is 125° F.

QJ8600-2
Nylon Double Swivel
1/4" FPT x QuickJet

Part No.
SS QJ8600-1/4NYB
SS QJ8600-2

Single Swivel with 1/4" FPT Inlet
Double Swivel with 1/4" FPT Inlet



Adapters

22674-1/4NYB
45° Angle Adapter
1/4" MPT x QuickJet



22669-1/4PPB
45° Angle Adapter
1/4" MPT x 11/16"-16 Thread for Std. Cap



QJ-1/4TNYB Adapter
1/4" FPT x QuickJet
QJT-NYB
11/16-16 Cap Thread x QJ Adapter



QJ-1/4TTNYB Adapter
1/4" MPT x QuickJet



QJ90-1NYR Nozzle Adapter
QuickJet Cap x 90° QuickJet Adapter

Part No.	Description
SS 22669-1/4PPB	45° Nozzle Body, 1/4" MPT x 11/16-16 thread
SS 22674-1/4NYB	45° Nozzle Body, 1/4" MPT x Quick TeeJet
SS QJ-1/4TNYB	Cap Adapter with 1/4" FPT Inlet
SS QJT-NYB	Cap Adapter with 11/16"-16 Cap Thread w/ Gasket
SS QJ-1/4TTNYB	Cap Adapter with 1/4" MPT Inlet
SS 19191EPR	Gasket for "QJT" Adaptors (Threaded end)
SS QJ90-1NYR	Quick Jet Cap x 90° Quick Jet Adapter

QuickJet Adapters

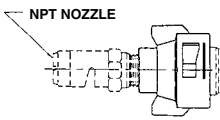

QJ4676-1/8NYR
QJ4676-1/4CEL
Adapters

1/8" or 1/4" FPT x QuickJet

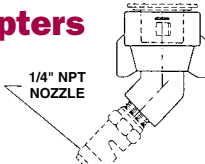

QJ4676-45-1/4
Adapter

45° 1/4" FPT x QuickJet

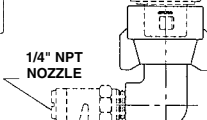

QJ4676-90-1/4
Adapter

90° 1/4" FPT x QuickJet

Part No.	Description
SS QJ4676-1/8NYR	1/8" FPT x QuickJet with EPDM Gasket
SS QJ4676-1/4CEL	1/4" FPT x QuickJet with EPDM Gasket
SS QJ4676-45-1/4	45° 1/4" FPT x QuickJet with EPDM Gasket
SS QJ4676-90-1/4	90° 1/4" FPT x QuickJet with EPDM Gasket



End Cap Assemblies for Diaphragm Check Valves

Nylon / Polypropylene Material
Less Diaphragm

End Cap Assemblies

Part No.	Opening Pressures	Color
SS 21950-2NYB	2 PSI	Yellow
SS 21950-5NYB	5 PSI	Black
SS 21950-8NYB	8 PSI	Black
SS 21950-10NYB	10 PSI	Black
SS 21950-15-NY	15 PSI	Red
SS 21950-20NYB	20 PSI	Black
SS CP21953-EPR	Raised EPR Diaphragm.....	
SS 21953VI	Raised Viton® Diaphragm ...	



1/8" Gauge Tubing Connectors

Part No.	Description
SS 21545NY	1/8" Tube Nut (See A).....
SS 21486NY	1/8" Union (See B).....
SS 21736NY	1/8"x3/16" Male Coupler + Tube Nut (See C)

Viton® is a registered trademark of DuPont Performance Elastomers

John Guest

Push to Connect Caps & Bodies

Both the QJ cap and check body incorporate *John Guest* end connections for use with 1/4" or 3/8" tube. This is a modified QJ8360NYB. EPDM o-ring in the *John Guest* insert. Mounting slots will accept 10-24 screws or can be cable-tied. Overall length of the cap/body assembly is 3-1/2".



90° Cap



Swivel Cap



Straight Cap



PTC Body



Part No.	Description
SS QJ98588-NYR	Straight QJ Cap for 1/4"
SS QJ114398-5/16	Straight QJ Cap for 5/16"
SS QJ98586-NYR	Straight QJ Cap for 3/8"
SS QJ98598-90-14	90° Cap for 1/4"
SS QJ98599-90-38	90° Cap for 3/8"
SS QJ98592-1/4-2	PTC Body for 1/4" Tube with 2# Check
SS QJ98592-1/4-5	PTC Body for 1/4" Tube 5# Check
SS QJ98592-1/4-10	PTC Body for 1/4" Tube with 10# Check
SS QJ114400-5/16-5	PTC Body for 5/16" Tube with 5# Check
SS QJ114400-5/16-10	PTC Body for 5/16" Tube with 10# Check
SS QJ98590-3/8-2	PTC Body for 3/8" Tube with 2# Check
SS QJ98590-3/8-5	PTC Body for 3/8" Tube with 5# Check
SS QJ98590-3/8-10	PTC Body for 3/8" Tube with 10# Check
SS QJ114403-1/4	1/4" 90° Swivel Cap with Gasket
SS QJ114404-5/16	5/16" 90° Swivel Cap with Gasket
SS QJ114403-3/8	3/8" 90° Swivel Cap with Gasket
SS 18999EPR	EPDM Gasket as Replacement

Caps Include EPDM Gasket.

QJ Vari-Spacing Clamps

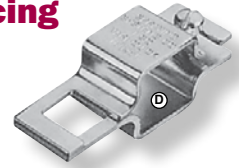
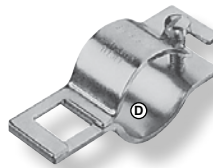

Vari-Spacing Clamps

QJ111-3/4	For 3/4" Pipe
QJ111-1	For 1" Pipe
QJ111-1-1/4	For 1-1/4" Pipe

Vari-Spacing Square Clamps

QJ111SQ-3/4	For 3/4" Square Tube
QJ111SQ-1	For 1" Square Tube
QJ111SQ-1-1/4	For 1-1/4" Square Tube
QJ125SS-1-1/4	For 1-1/4" Square Tube
QJ111SQ-1-1/2	For 1-1/2" Square Tube

Part No.	Description	Discount
SS QJ111-3/4	Vari-Clamp for 3/4" Pipe	10%
SS QJ111-1	Vari-Clamp for 1" Pipe	10%
SS QJ111-1-1/4	Vari-Clamp for 1-1/4" Pipe	10%
SS QJ111SQ-3/4	Vari-Clamp for 3/4" Square Tube	10%
SS QJ111SQ-1	Vari-Clamp for 1" Square Tube	10%
SS QJ111SQ-1-1/4	Vari-Clamp for 1-1/4" Square Tube	10%
SS QJ111SQ-1-1/2	Vari-Clamp for 1-1/2" Square Tube	10%
SS QJ125SS-1-1/4	Vari-Clamp Stainless Steel for 1-1/4" Sq. Tube	10%



Fantastic people, My first call when I need something.

"Always one of my first calls when I need something, I mainly work with the guys in Omaha. They are by far the best guys to work with. I have never had to wait very long to get an answer about a question I couldn't answer right away, parts that I order are always correct, if there is a backordered part or parts I am told up front and know the timeline. They all deserve a pay raise."

Paul - Green Line Equipment