

Ball Bearing Swivels

Completely Rebuildable
Pressures to 3500 PSI

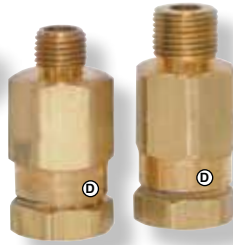

High Pressure Swivel with Brass body and Stainless Steel thrust bearings. Internally lubricated O-rings and 303 Stainless center spool piece assure long trouble-free operation. Pressures to 3500 PSI. Maximum temperature is 160° F.



| Part No. | Pipe Thread Ports | Max. PSI |
|-------------|------------------------------------|----------|
| FL SW504 | 1/4" MPT x 1/4" FPT | 2000 |
| FL SW504A | 3/8" MPT x 3/8" FPT | 2000 |
| FL SW504HP | 1/4" MPT x 1/4" FPT | 3500 |
| FL SW504AHP | 3/8" MPT x 3/8" FPT | 3500 |
| FL RK550 | Repair Kit for swivels above | |

SMC SWIVELS



2400-32 or 2400-34

Ball Bearing Swivels are of Electroless Nickel plated Brass construction. Cap ends are precision machined for heavy-duty leak proof service. High pressure seal is Buna-N. Bearing seal is vented between the high pressure seal. Maximum pressure is 1500 PSI. Maximum Temperature is 180° F.



2400-31 or 2400-33

| Part No. | Pipe Thread Ports |
|-------------|------------------------------|
| SM 2400-31 | 1/4" MPT x 1/4" FPT |
| SM 2400-32 | 1/4" FPT x 1/4" FPT |
| SM 2400-33 | 3/8" MPT x 3/8" FPT |
| SM 2400-34 | 3/8" FPT x 3/8" FPT |
| SM 523-0690 | Repair Kit for above swivels |

SUTTNER Swivels

High Pressure Swivels from Suttner! Available in 3/8" MPT x FPT or 3/8" FPT x FPT. Rated to 5000 PSI. Maximum temperatures to 300° F. Rated to 12 GPM. Nickel-plated brass or stainless construction. Rebuildable design. Teflon seal.

| Part No. | Ports | Type |
|-----------|------------------|-----------|
| NP ST300 | 3/8" M x F | Brass |
| NP ST325 | 3/8" F x F | Brass |
| NP ST310 | 3/8" M x F | Stainless |
| NP ST300K | Repair Kit | |



SUTTNER High Flow Swivels

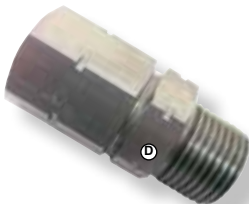

High Flow, 1/2" Swivels from Suttner! Available in Nickel-Plated Brass or Stainless construction. Teflon rings allow temperatures to 212° F. Rated to 3200 PSI and 42 GPM. Ports are 1/2" male inlet x 1/2" female outlet

| Part No. | Type |
|-----------|----------------------------|
| NP ST340 | High Flow Swivel Brass |
| NP ST340S | High Flow Swivel Stainless |

Break-Away Gun/Wand Fittings

— Brass —

Mounts between hose and gun, designed to break before damage to gun or wand. Available in 1/4" or 3/8". Rated to 5,800 PSI.



| Part No. | Pipe Thread Ports |
|----------|-------------------|
| AA 5068 | 1/4" MPT x FPT |
| AA 5069 | 3/8" MPT x FPT |



High Pressure Wand Swivels

Wand Swivels from General Pump. Ideal car and truck wash, pressure washer, industrial cleaning and mobile washing. **D100 Series** are brass or stainless and have Buna seals rated to 195° F. **DSWG38SS** is stainless with Viton® seals, rated to 250° F.

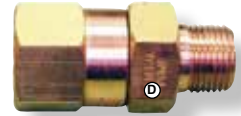

| Part No. | Material | Size | Flow | Pressure |
|-------------|-----------|----------|--------|----------|
| IP D10066 | Brass | 3/8" MxF | 10 GPM | 4000 PSI |
| IP D10067 | Stainless | 3/8" MxF | 10 GPM | 5000 PSI |
| IP DSWG38SS | Stainless | 3/8" MxF | 15 GPM | 5000 PSI |

High Pressure Wand Swivels

High Pressure Gun Swivels. Brass or stainless steel construction. Rebuildable design. Rated to 200° F. Brass rated to 3,000 PSI. Stainless rated to 5,000 PSI.

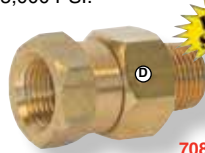

7080

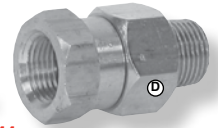

7044

| Part No. | Material | Size | Max. PSI |
|----------|------------------------------------|------------|----------|
| AA 7045 | Brass | 3/8" F X F | 3000 |
| AA 7080 | Brass | 3/8" M x F | 3000 |
| AA 7044 | Stainless | 3/8" M x F | 5000 |
| AA 7084 | Repair Kit for above swivels | | |



Wand Swivels



Easy Turn Wand Swivels from Mosmatic. High quality Swiss engineering. 4000 PSI models are nickel-plated brass. 7300 PSI models are stainless steel. Buna O-ring are standard but EPDM or Viton® are available in some models. Rated to 250° F.

| Part No. | Ports | Max. PSI |
|----------|-----------------------|----------|
| MM 32557 | 1/4" FPT x 1/4" FPT | 4000 |
| MM 32552 | 1/4" MPT x 1/4" FPT | 4000 |
| MM 32569 | 3/8" FPT x 3/8" FPT | 4000 |
| MM 32769 | 3/8" FPT x 3/8" FPT | 7300 |
| MM 32564 | 3/8" MPT x 3/8" FPT | 4000 |
| MM 32852 | * 3/8" MPT x 3/8" FPT | 4000 |
| MM 32764 | 3/8" FPT x 3/8" FPT | 7300 |
| MM 32563 | 3/8" MPT x 3/8" MPT | 4000 |
| MM 32763 | 3/8" MPT x 3/8" MPT | 7300 |
| MM 32562 | 3/8" MPT x 1/4" FPT | 4000 |
| MM 32561 | 3/8" MPT x 1/4" MPT | 4000 |
| MM 32863 | 1/2" MPT x 1/2" MPT | 4000 |
| MM 32864 | 1/2" MPT x 1/2" FPT | 4000 |
| MM 32894 | 1/2" MPT x 1/2" FPT | 7300 |

* 3/8" Flow Path.

CALL for CURRENT PRICING

Spraying Systems High Pressure Swivels

Stainless Steel or brass construction. Bearings are self-lubricated Teflon filled acetal for long life and low torque requirements. Maximum temperature is 200° F. Ports are 3/8" FPT x 3/8" MPT.



| Part No. | Material | Max. PSI |
|------------|-----------------------|----------|
| SS 15950SS | Stainless Steel | 3000 |
| SS 15950B | Brass | 3000 |
| SS AB15950 | Repair Kit | |

Medium Pressure Swivels



Ideal for applications up to 1000 PSI. No Ball Bearings to gall or rust. All Brass Body. Available in 1/4", 3/8" and 1/2" sizes. Non-repairable.

| Part No. | Pipe Thread Ports | Max. PSI |
|------------|---------------------|----------|
| SM 902-1/4 | 1/4" MPT x 1/4" FPT | 1000 |
| SM 900-3/8 | 3/8" FPT x 3/8" MPT | 1000 |
| SM 901-1/2 | 1/2" FPT x 1/2" MPT | 1000 |

Viton® is a registered trademark of DuPont Performance Elastomers